



Vision • Commitment • Pride

FOREST STEWARDSHIP MANAGEMENT PLAN

Prepared For:
Quitman School District

Prepared By:
T Michael Crowell
MFC

Time Period Covered by This Plan:
2012 - 2021

Date Plan Prepared:
2012-01-23

Plan Type:
Stewardship / Stewardship

This plan was developed in accordance with the rules of the Stewardship program.

Property Name: S16_T3N_R16E

TABLE OF CONTENTS

LANDOWNER INFORMATION	3
FORESTER INFORMATION	3
INTRODUCTION	3
OBJECTIVES	3
PROPERTY DESCRIPTION	4
GENERAL PROPERTY RECOMMENDATIONS	5
SOIL TYPES	7
STRATA	9
OTHER PLAN ACTIVITIES	15
PLAN MAP	16
PLAN MAP	17
STRATA ACTIVITY SCHEDULE	18

**MISSISSIPPI FORESTRY COMMISSION
FOREST STEWARDSHIP MANAGEMENT PLAN**

LANDOWNER INFORMATION

Name: Quitman School District
Mailing Address: 104 East Franklin Street
City, State, Zip: Quitman, MS 39355
Country: United States of America
Contact Numbers: Home Number:
Office Number: 601-776-2186
Fax Number:
E-mail Address: gfleming@qsd.k12.ms.us
Social Security Number (optional): 640442029

FORESTER INFORMATION

Name: T Michael Crowell , Service Forester
Forester Number: 01207
Organization: MFC
Street Address: P.O. Box 174
City, State, Zip: Quitman, MS 39355
Contact Numbers: Office Number: 601-776-6213
Fax Number: 601-776-1010
E-mail Address: mcrowell@mfc.state.ms.us

PROPERTY LOCATION

County: Clarke Total Acres: 645 Latitude: -88.66 Longitude: 32.1
Section: 16 Township: 3N Range: 16E

INTRODUCTION

This Forest Stewardship Management Plan will serve as a guide for accomplishing the goals and objectives for your property. In addition to addressing your specific goals and objectives, this plan includes recommendations for maintaining soil and water quality and protecting your forest from insects, disease, and wildfire. Recommendations are based on observation and assessment of the site.

OBJECTIVES

Timber Production

The goal is to produce high quality sawtimber. This will be accomplished through reforestation and timber stand improvement practices such as herbicide applications, prescribed burning, thinning at specified intervals, and other silvicultural practices. Forestry Best Management Practices will be implemented to prevent erosion and protect water quality.

Wildlife Management - General

The goal is to provide a diversity of habitats suitable for a variety of game and non-game wildlife species. Habitat management will focus on developing a variety of food, cover, water, and space. This will be accomplished by establishing and maintaining access roads

**MISSISSIPPI FORESTRY COMMISSION
FOREST STEWARDSHIP MANAGEMENT PLAN**

and firelanes, providing openings within the forest, and the management of trees located within the Streamside Management Zone

PROPERTY DESCRIPTION

General Property Information

General

This section, which consists of approximately one full section of land (643.28 acres), is located in the north central portion of Clarke County, being more specifically located two miles east of Clarkco State Park. The County Road 140 goes through this section in the north and west side. The headwaters of Peach Tree Creek and Ivy Mill Creek originate in this section. The entire section is timbered land except 18.34 acres. The non-forested acres include 3 acres for Mont Rose Church and cemetery, and public road right of way and woods roads. Access to the section is good and access on the section is good.

History

Silvicultural work has been accomplished on this section since the signing of the first Timber Management and Marketing Agreement between the Board of Supervisors and the Mississippi Forestry Commission. Boundary Lines are brushed out and repainted on a regular basis. Good Silvicultural Forestry Management Practices are conducted on this section as needed. Fire lane and road maintenance is done as needed.

Wildlife and Recreation

Hunting is the primary form of recreation taking place on this section. Game species most frequently hunted are deer, turkey and squirrel. There is some very good habitat for these species; therefore any timber management practices to be implemented should consider the recreational and wildlife management aspects as such as is feasible.

Problems

No problems of any serious consequence are found on this section at this time.

Water Resources

The headwaters of Peach Tree Creek and Ivy Mill Creek originate in this section. These intermittent streams and drains will be maintained in accordance with Mississippi's Best Management Practices.

Timber Production

The goal is to maximize the production of high quality timber. This will be accomplished through the application of timely thinning and other silvicultural practices designed to enhance timber quality and growth. Forestry Best Management Practices will be implemented to prevent erosion and protect water quality.

**MISSISSIPPI FORESTRY COMMISSION
FOREST STEWARDSHIP MANAGEMENT PLAN**

Archeological or Cultural Resources:

Archeological or Cultural Resources Were Identified:

A cemetery and church, exists in the westcentral portion of the section as indicated on the attached map. This site has been buffered and designated with fence around the cemetery site. No forest management activities will occur inside of this protected area.

Threatened and Endangered Species

No threatened and endangered species were identified during the reconnaissance and evaluation of your property.

Interaction with Surrounding Property

Prescribed practices should be carried out in a manner that will minimize adverse impacts on surrounding properties. Consideration should be given to potential air, water, visual, and other impacts. In addition, practices carried out should have positive effects on the surrounding community such as improved wildlife habitat and soil stabilization.

Soils General

Soils were evaluated on the property to determine the suitability of the site for the proposed activities. Forest practices were planned so as to minimize erosion or other adverse effects on the soil. The following soils are identified for this property from soils index map number 41 of the 1961 soil survey of Clarke County: Bibb/Chastain, Boswell/Shubuta/Cuthbert, Shubuta, and Eustis.

GENERAL PROPERTY RECOMMENDATIONS

Forest Protection

A healthy vigorously growing stand is the best defense to an attack from a variety of forest insects, plants and pathogens.

Insects and Diseases

Trees are subject to attack from insects and diseases. Different insects and diseases affect trees according to the age, species, and condition of the trees. Planted stands of pines and pure stands of hardwoods are particularly susceptible to attack. Since there are many different insects and diseases, no attempt will be made here to explain all of them. The property should be inspected at least annually for possible signs of insect and disease activity. Some things to look for are:

- Unseasonable leaf fall
- Discoloration of leaves or needles
- Pitch pockets on pine trees
- Heavy defoliation of hardwood leaves
- Groups of three or more dying trees within a stand

This list does not cover all instances of insect or disease attacks. If anything unusual is noticed, report it to a forester. In most cases, insect and disease problems can be controlled if discovered early.

MISSISSIPPI FORESTRY COMMISSION FOREST STEWARDSHIP MANAGEMENT PLAN

Fire Protection

Your forest should be protected from wildfire at all times. The best way to protect your investment is by establishing and maintaining firebreaks around the property. Guidelines for establishment and maintenance of firebreaks may be found in Mississippi Forestry Commission publication #107, *Mississippi's Best Management Practices*

Grazing

Tree seedlings should be protected from grazing until such time as the terminal bud of the sapling is beyond reach of livestock. Domestic livestock should be denied access to the tree planting area.

Boundary Lines

It is the responsibility of the landowner to ensure that all property lines and boundaries designating areas to receive forestry work are clearly identified and visible to all contractors.

Note: Some forest practices may cause temporary adverse environmental or aesthetic impacts. These practices will only cause short-term adverse impacts where they are installed. Special efforts will be made to minimize adverse effects when carrying out any of the practices. Examples include: site preparation, planting, prescribed fires, firebreak installation and maintenance, road installation and maintenance, pesticide applications and timber harvesting.

Water Quality Protection

The objective of the landowner is to protect, preserve and enhance all water sources on or transecting the property. This can best be achieved by implementation of Best Management Practices in all aspects of the management of the property.

Aesthetics

The goal is to assure that the property is managed in such a way that is aesthetically pleasing to the landowner as well as the community. Activities could include, maintaining buffer strips along the road and adjacent to the home site, planting wildflowers along the road, and trees with attractive fall and spring color along the drive and near the home site.

Ecological Restoration

Ecological restoration is the process of assisting the recovery of an ecosystem that has been degraded, damaged, or destroyed. A reconnaissance of the property has been conducted and no ecological restoration activities are recommended at this time.

Wildlife Mgt. Target Species

The objective of this practice is to provide habitat best suited for the featured or target species. Habitat management will focus on providing food, cover, water, and space to facilitate the target species.

**MISSISSIPPI FORESTRY COMMISSION
FOREST STEWARDSHIP MANAGEMENT PLAN**

Environmental Education

Environmental educational goals are to provide educational opportunities for children and adults through the development of items such as nature trails with tree identification markers, wildlife viewing areas, picnic areas, parking, public restroom facilities.

Wildlife Management General

The goal is to provide a diversity of habitats suited for a variety of game and non-game wildlife species. Habitat management will focus on providing a variety of food, cover, water, and space. This will be accomplished, in part, by establishing and maintaining access roads and firelanes, providing openings within the forest, and leaving mast producing and den trees.

Timber Management

Timber management goals for this property are to manage timber resources in such a manner as to maximize timber production throughout the life of the stand.

Recreation

According to landowner objectives the recreational use of the property could prove to be an avenue for personal enjoyment or for generating income. An evaluation of your property should be conducted and a plan developed to accomplish your specific goals for recreational activities on your property.

SOIL TYPES

Smithdale

The Smithdale component makes up 90 percent of the map unit. Slopes are 8 to 12 percent. This component is on hillslopes. The parent material consists of loamy fluviomarine deposits. Depth to a root restrictive layer is greater than 60 inches. The natural drainage class is well drained. Water movement in the most restrictive layer is moderately high. Available water to a depth of 60 inches is high. Shrink-swell potential is low. This soil is not flooded. It is not ponded. There is no zone of water saturation within a depth of 72 inches. Organic matter content in the surface horizon is about 1 percent. Nonirrigated land capability classification is 4e. This soil does not meet hydric criteria. Loblolly Site Index = 86. Longleaf Site Index = 69. Slash Site Index = 85.

Shubuta

The Shubuta component makes up 90 percent of the map unit. Slopes are 5 to 8 percent. This component is on uplands. The parent material consists of clayey marine deposits. Depth to a root restrictive layer is greater than 60 inches. The natural drainage class is well drained. Water movement in the most restrictive layer is moderately high. Available water to a depth of 60 inches is moderate. Shrink-swell potential is moderate. This soil is not flooded. It is not ponded. There is no zone of water saturation within a depth of 72 inches. Organic matter content in the surface horizon is about 2 percent. Nonirrigated land capability classification is 3e. This soil does not meet hydric criteria. Loblolly Site Index = 80.

**MISSISSIPPI FORESTRY COMMISSION
FOREST STEWARDSHIP MANAGEMENT PLAN**

Sweatman

The Sweatman component makes up 40 percent of the map unit. Slopes are 12 to 35 percent. This component is on uplands. The parent material consists of loamy marine deposits. Depth to a root restrictive layer is greater than 60 inches. The natural drainage class is well drained. Water movement in the most restrictive layer is moderately high. Available water to a depth of 60 inches is moderate. Shrink-swell potential is moderate. This soil is not flooded. It is not ponded. There is no zone of water saturation within a depth of 72 inches. Organic matter content in the surface horizon is about 1 percent. Nonirrigated land capability classification is 7e. This soil does not meet hydric criteria.

The Sweatman component makes up 30 percent of the map unit. Slopes are 12 to 35 percent. This component is on uplands. The parent material consists of loamy marine deposits. Depth to a root restrictive layer is greater than 60 inches. The natural drainage class is well drained. Water movement in the most restrictive layer is moderately high. Available water to a depth of 60 inches is moderate. Shrink-swell potential is moderate. This soil is not flooded. It is not ponded. There is no zone of water saturation within a depth of 72 inches. Organic matter content in the surface horizon is about 1 percent. Nonirrigated land capability classification is 7e. This soil does not meet hydric criteria.

Bibb

The Bibb component makes up 60 percent of the map unit. Slopes are 0 to 2 percent. This component is on flood plains. The parent material consists of sandy and loamy alluvium deposits. Depth to a root restrictive layer is greater than 60 inches. The natural drainage class is poorly drained. Water movement in the most restrictive layer is moderately high. Available water to a depth of 60 inches is moderate. Shrink-swell potential is low. This soil is frequently flooded. It is not ponded. A seasonal zone of water saturation is at 9 inches during January, February, March, April, December. Organic matter content in the surface horizon is about 2 percent. Nonirrigated land capability classification is 5w. This soil meets hydric criteria.

The Una component makes up 30 percent of the map unit. Slopes are 0 to 2 percent. This component is on flood plains. The parent material consists of clayey alluvium. Depth to a root restrictive layer is greater than 60 inches. The natural drainage class is poorly drained. Water movement in the most restrictive layer is very low. Available water to a depth of 60 inches is high. Shrink-swell potential is high. This soil is frequently flooded. It is not ponded. A seasonal zone of water saturation is at 9 inches during January, February, March, April, November, December. Organic matter content in the surface horizon is about 2 percent. Nonirrigated land capability classification is 4w. This soil meets hydric criteria.

Ruston

The Ruston component makes up 95 percent of the map unit. Slopes are 5 to 8 percent. This component is on coastal plains. The parent material consists of loamy fluviomarine deposits. Depth to a root restrictive layer is greater than 60 inches. The natural drainage class is well drained. Water movement in the most restrictive layer is moderately high. Available water to a depth of 60 inches is moderate. Shrink-swell potential is low. This soil is not flooded. It is not ponded. There is no zone of water saturation within a depth of 72 inches. Organic matter content in the surface horizon is about 2 percent. Nonirrigated land capability classification is 3e. This soil does not meet hydric criteria. Loblolly Site Index = 84.

**MISSISSIPPI FORESTRY COMMISSION
FOREST STEWARDSHIP MANAGEMENT PLAN**

STRATA

Strata 1

Stands 2, 7, 10, 11, and 15

Total Acres : 132.74

Strata Description

Strata 1 is described as pine chip-n-saw.

Stand 2: 37.16 acres

Stand 10: 6.58 acres

Stand 11: 30.18 acres

These three (3) stands are 20 year old, well stocked, loblolly pine plantations. The stands were thinned in 2008.

Stand 7: 31.17 acres

Stand 15: 27.65 acres

These two (2) stands are 23 year old, well stocked, loblolly pine plantations. The stands were thinned in 2009.

Strata Recommendations

In this strata, the stands will be managed to a 35 year rotation. During this time frame, management activities such as thinnings, mid-rotation release, and prescribed burning to improve wildlife habitat will be used to keep stands in full production.

Activity Recommendations

Fire Protection

A prescribed fire is recommended for stand 2, 7, 10, 11, and 15 in 2013, 2016, 2018, and again in 2021. The burn will reduce fuel loading and the potential for a wildfire to occur. A prescribed burning plan must be developed and followed in the application of the burn. Because of equipment, personnel and weather requirements, the application of a prescribed fire is limited to only those days that meet requirements of the burning plan. A certified prescribed burning manager should be employed to conduct the burn. The Mississippi Forestry Commission (on a limited basis) and other certified prescribed burning vendors are available to conduct prescribed burning.

Harvest

A second thin will be made on stands 2, 10, and 11 in 2016

A second thin will be made on stand 7 and 15 in 2017.

**MISSISSIPPI FORESTRY COMMISSION
FOREST STEWARDSHIP MANAGEMENT PLAN**

The areas will be cruised to determine how much volume will be removed as well as the value of the timber to be removed.

Strata 2

Stands 3 and 9

Total Acres : 38.43

Strata Description

Strata 2 is described as pine pulpwood.

Stand 3: 20.73 acres

Stand 9: 17.70 acres

These two (2) stands are 14 year old, well stocked, loblolly pine plantations.

Strata Recommendations

In this strata, the stands will be managed to a 35 year rotation. During this time frame, management activities such as thinnings, mid-rotation release, and prescribed burning to improve wildlife habitat will be used to keep stands in full production.

Activity Recommendations

Fire Protection

A prescribed fire is recommended for stands 3 and 9 in 2012, 2015, 2018, and again in 2021. The burn will reduce fuel loading and the potential for a wildfire to occur. A prescribed burning plan must be developed and followed in the application of the burn. Because of equipment, personnel and weather requirements, the application of a prescribed fire is limited to only those days that meet requirements of the burning plan. A certified prescribed burning manager should be employed to conduct the burn. The Mississippi Forestry Commission (on a limited basis) and other certified prescribed burning vendors are available to conduct prescribed burning.

Harvest

A first thin will be made on stands 3, and 9 in 2013. The area will be cruised to determine how much volume will be removed as well as the value of the timber to be removed.

Strata 3

Stands 5, 6, 12, 14, 17, and 18

Total Acres : 216.75

**MISSISSIPPI FORESTRY COMMISSION
FOREST STEWARDSHIP MANAGEMENT PLAN**

Strata Description

Strata 3 is described as sawtimber.

Stand 5: 155.51 acres

This Stand is a mixed pine stand with mixed hardwoods. The age is 45 to 55 years old. This stand is well stocked.

Stand 6: 15.49 acres

This Stand is a mixed hardwood stand with scattered pines between 45 to 55 years old. This stand has a 5 acre white oak stand in the south east corner. This stand is well stocked.

Stand 12: 7.89 acres

Stand 14: 25.63 acres

Stand 17: 7.68 acres

Stand 18: 4.55 acres

These four (4) stands are mixed hardwood stands with scattered pines between 45 and 55 years old. This stand is a smz.

Strata Recommendations

In this strata, the stands will be managed to a 50 to 60 year rotation. During this time frame, management activities such as thinning will be considered. Measures will be made to improve wildlife habitat will be used to keep stands in production. The smz will be maintained.

Activity Recommendations

Fire Protection

A prescribed fire is recommended for stand 5 in 2013. The burn will reduce fuel loading and the potential for a wildfire to occur. A prescribed burning plan must be developed and followed in the application of the burn. Because of equipment, personnel and weather requirements, the application of a prescribed fire is limited to only those days that meet requirements of the burning plan. A certified prescribed burning manager should be employed to conduct the burn. The Mississippi Forestry Commission (on a limited basis) and other certified prescribed burning vendors are available to conduct prescribed burning.

Harvest

Stand 6 is scheduled for a regeneration cut in 2013.

Stand 5 is scheduled for a regeneration cut in 2015.

**MISSISSIPPI FORESTRY COMMISSION
FOREST STEWARDSHIP MANAGEMENT PLAN**

The timber will be cruised to determine the value of the stand. The actual sale acres will be determined using GPS mapping techniques and the stand will be cruised to determine the value of the sale. The Stream Side Management Zones (SMZ's) will be protected throughout the logging operations.

Site Preparation

In stand 6, site preparation in the form of aerial herbicides will be applied when substantial sprouting of woody vegetation has occurred. The application date is scheduled for summer/fall 2014. The herbicide will be applied in accordance with it's labeling.

Site Preparation

In stand 6, burning, thirty (30) to sixty (60) days after the application of aerial herbicides, will be scheduled. This burn will be conducted to eliminate logging slash and to help promote a good tree planting effort. A prescribed burning plan must be developed and followed in the application of the burn. Because of equipment, personnel and weather requirements, the application of a prescribed fire is limited to only those days that meet requirements of the burning plan. A certified prescribed burning manager should be employed to conduct the burn. The Mississippi Forestry Commission and other certified prescribed burning vendors are available to conduct prescribed burning. Burning will be conducted when and if conditions are favorable for a safe and successful burn. Every effort will be made to have the area burned prior to planting.

Regeneration

In stand 6, the area will be planted with Loblolly pine seedlings at a rate of 605 trees per acre. Every effort will be made to locate the best seedling available on the market. Planting is scheduled for January 2015.

Site Preparation

In stand 5, site preparation in the form of aerial herbicides will be applied when substantial sprouting of woody vegetation has occurred. The application date is scheduled for summer/fall 2017. The herbicide will be applied in accordance with it's labeling.

Site Preparation

In stand 5, burning, thirty (30) to sixty (60) days after the application of aerial herbicides, will be scheduled. This burn will be conducted to eliminate logging slash and to help promote a good tree planting effort. A prescribed burning plan must be developed and followed in the application of the burn. Because of equipment, personnel and weather requirements, the application of a prescribed fire is limited to only those days that meet requirements of the burning plan. A certified prescribed burning manager should be employed to conduct the burn. The Mississippi Forestry Commission and other certified prescribed burning vendors are available to conduct prescribed burning. Burning will be conducted when and if conditions are favorable for a safe and successful burn. Every effort will be made to have the area burned prior to planting.

**MISSISSIPPI FORESTRY COMMISSION
FOREST STEWARDSHIP MANAGEMENT PLAN**

Regeneration

In stand 5, the area will be planted with Loblolly pine seedlings at a rate of 605 trees per acre. Every effort will be made to locate the best seedling available on the market. Planting is scheduled for January 2018.

Strata 5

Stands 1 and 8

Total Acres: 197.38

Strata Description

Strata 5 is described as sub-merchantable pine plantation.

Stand 1: 79.32 acres

This stand is a 9 year old, well stocked, loblolly pine plantation.

Stand 8: 118.06 acres

This stand is a 12 year old, well stocked, loblolly pine plantation.

Strata Recommendations

In this strata, the stands will be managed to a 35 year rotation. During this time frame, management activities such as thinnings, mid-rotation release, and prescribed burning to improve wildlife habitat will be used to keep stands in full production.

Activity Recommendations

Fire Protection

A prescribed fire is recommended for stand 8, in 2014 and again in 2018 and 2021.

A prescribed fire is recommended for stand 1, in 2016 and again in 2021.

The burn will reduce fuel loading and the potential for a wildfire to occur. A prescribed burning plan must be developed and followed in the application of the burn. Because of equipment, personnel and weather requirements, the application of a prescribed fire is limited to only those days that meet requirements of the burning plan. A certified prescribed burning manager should be employed to conduct the burn. The Mississippi Forestry Commission (on a limited basis) and other certified prescribed burning vendors are available to conduct prescribed burning.

Harvest

A first thin will be made on stand 8, in 2015.

A first thin will be made on stand 1 in 2017.

**MISSISSIPPI FORESTRY COMMISSION
FOREST STEWARDSHIP MANAGEMENT PLAN**

The areas will be cruised to determine how much volume will be removed as well as the value of the timber to be removed.

Strata 6
Stands 4

Total Acres: 41.68

Stand Description

Strata 6 is described as cutover.

Stand 4: 41.68 acres

This stand is a 41.68 acre cutover with mixed pine and hardwood slash. The terrain is gently sloping and is suitable for loblolly pine.

Strata Recommendations

In this strata, the stands will be managed to a 35 year rotation. During this time frame, management activities such as thinnings, mid-rotation release, and prescribed burning to improve wildlife habitat will be used to keep stands in full production.

Activity Recommendations

Site Preparation

In stand 4, site preparation in the form of aerial herbicides will be applied when substantial sprouting of woody vegetation has occurred. The application date is scheduled for summer/fall 2012. The herbicide will be applied in accordance with its labeling.

Site Preparation

In stand 4, burning, thirty (30) to sixty (60) days after the application of aerial herbicides, will be scheduled. This burn will be conducted to eliminate logging slash and to help promote a good tree planting effort. A prescribed burning plan must be developed and followed in the application of the burn. Because of equipment, personnel and weather requirements, the application of a prescribed fire is limited to only those days that meet requirements of the burning plan. A certified prescribed burning manager should be employed to conduct the burn. The Mississippi Forestry Commission and other certified prescribed burning vendors are available to conduct prescribed burning. Burning will be conducted when and if conditions are favorable for a safe and successful burn. Every effort will be made to have the area burned prior to planting.

Regeneration

In stand 4, the area will be planted with Loblolly pine seedlings at a rate of 605 trees per acre. Every effort will be made to locate the best seedling available on the market. Planting is scheduled for January 2013.

**MISSISSIPPI FORESTRY COMMISSION
FOREST STEWARDSHIP MANAGEMENT PLAN**

OTHER PLAN ACTIVITIES

Boundary Lines

Routine inspections and general maintenance of the boundary lines will ensure overall appearance and aesthetics of the property.

Line Description

This section has approximately 4 miles of boundary lines. These lines are painted with "Red " boundary line paint. Lines are maintained periodically.

Line Recommendations

The boundary lines are scheduled for repainting every 5 years.

Activity Recommendations

Property Activities

The boundary lines are scheduled for repainting in 2016 and again 2021.

Property Activities

Routine inspections and general maintenance of the roads, Firelanes, and boundary lines will ensure overall appearance and aesthetics of the property.



Quitman School District

16-3N-16E
2012 to 2021
645.32 Acres

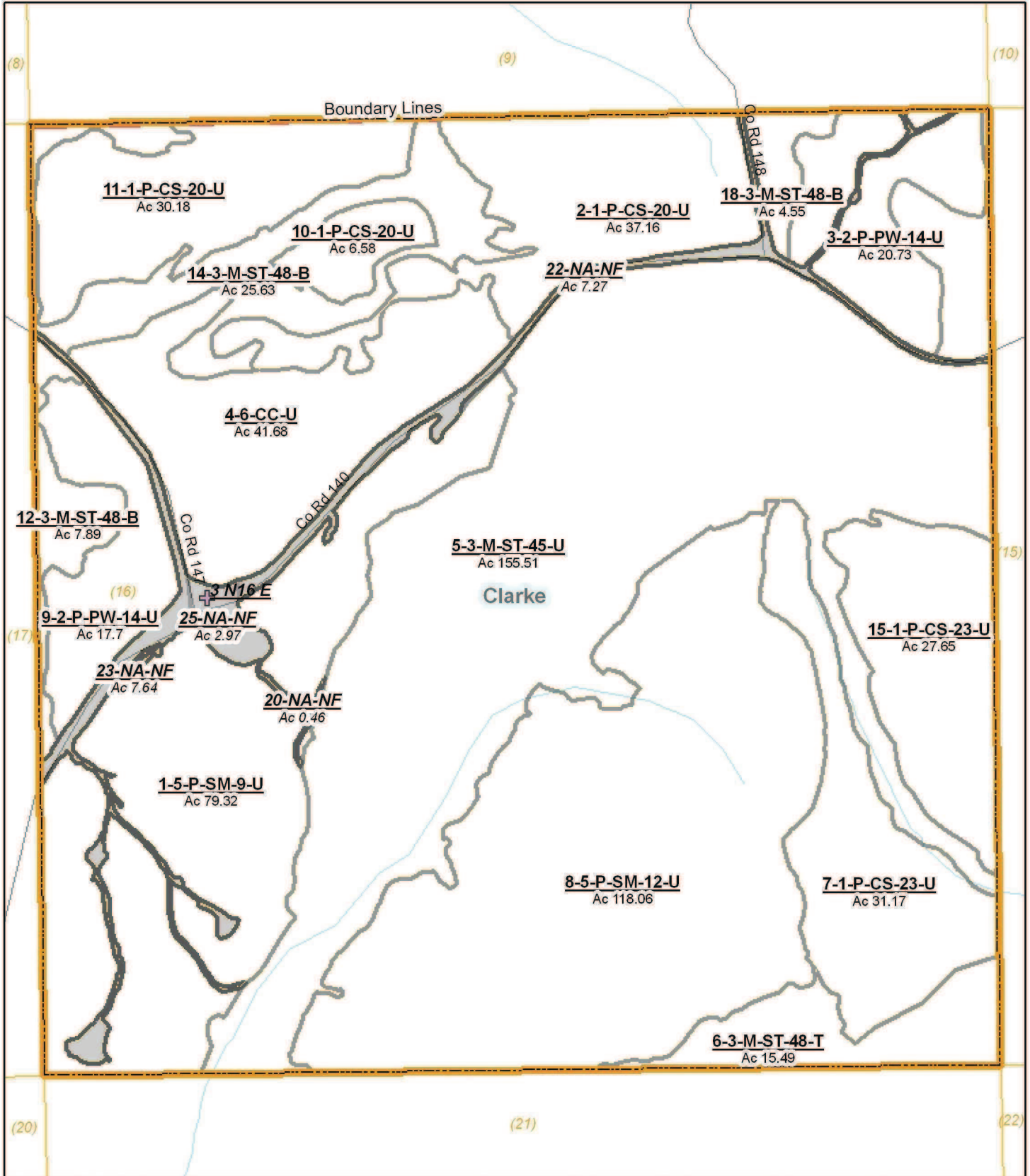

(01/26/2012)

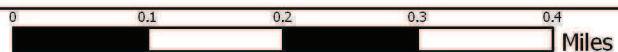

16-3N-16E



Property

- Property

Restricted Sites

- Archeology
- Cemetery
- Red-Cockaded Woodpecker
- Gopher Tortoise
- Picture Bogg Plant

Hydrology (Points)

- Concrete Dam
- Beaver Dam
- Earthen Dam
- Permanent
- Temporary
- Wooden
- Other
- Culvert
- Pond

Boundary Corners

- Property
- Section
- Quarter Section
- Areas

Property Roads/Trails

- Drive Ways
- Access Road
- Logging Road
- Skid Trail
- Farm Road
- Hiking Trail
- Horseback Riding Trail

Boundary Lines

- Archeology

Boundary Lines (cont)

- Cemetery
- Drilling Sites
- Education
- Forest Health
- Invasive Species
- Management Compartment
- Military Area
- Natural Area
- Property
- Recreation
- Rights of Way
- SMZ
- Special Use
- Stand
- Surface Mining
- Threatened/Endangered Species
- Visual Buffer

Restricted Area

- SMZ
- Archeology,
- Cemetery
- Visual Buffer
- Special Use
- Natural Area
- Education
- Recreation
- Military Area
- Large Utility
- Red-Cockaded Woodpecker
- Gopher Tortoise
- Picture Bogg Plant
- Coal
- Gravel
- Dirt
- Water
- Oil

Restricted Area (cont)

- Natural Gas

Transportation (Lines)

- City Streets
- County Roads
- 3 Digit Highway
- Interstate Highway
- US Highway
- State Highway
- Natchez Trace Parkway
- Runways/Airports
- Active RR
- Abandoned RR

Hydrology (Lines)

- Mississippi River
- Major River
- Primary Stream
- Intermittent Stream
- Canal
- Ditch
- Earthen Dam
- Concrete Dam

Utilities (Lines)

- Large Electrical
- Local Utility
- Large Pipeline
- Small Pipeline
- Gas Line
- Utility Line
- Water Line

Stand Activity Summary for
Quitman School District
16 3N 16E

Filters Applied: County: Clarke
Client Class: School Trust Land
District: South Central District
Client: Quitman School District
STR: 16 3N 16E
Activity:
Year: 2012 Through 2021

STR	Strata	Stand	Activity	Acre	Est. Cost	Est. Revenue
2012						
16 3N 16E	2	3	Fire Protection, Other, Burn, Hand, Fuel Reduction	21	\$525.00	\$0.00
16 3N 16E	2	9	Fire Protection, Other, Burn, Hand, Fuel Reduction	18	\$450.00	\$0.00
16 3N 16E	6	4	Site Preparation, Other, Burn, Hand, Cut-Over	42	\$1,050.00	\$0.00
16 3N 16E	6	4	Site Preparation, Chemical, Band, Hand, Combination	42	\$4,200.00	\$0.00
Yearly Totals				123	\$6,225.00	\$0.00
2013						
16 3N 16E	1	2	Fire Protection, Other, Burn, Hand, Fuel Reduction	37	\$925.00	\$0.00
16 3N 16E	1	7	Fire Protection, Other, Burn, Hand, Fuel Reduction	31	\$775.00	\$0.00
16 3N 16E	1	10	Fire Protection, Other, Burn, Hand, Fuel Reduction	7	\$175.00	\$0.00
16 3N 16E	1	11	Fire Protection, Other, Burn, Hand, Fuel Reduction	30	\$750.00	\$0.00
16 3N 16E	1	15	Fire Protection, Other, Burn, Hand, Hazard Mitigation	28	\$700.00	\$0.00
16 3N 16E	2	3	Harvest, Mechanical, 1st Thin, Machine, Loblolly	21	\$735.00	\$9,622.62
16 3N 16E	2	9	Harvest, Mechanical, 1st Thin, Machine, Loblolly	18	\$630.00	\$7,500.96
16 3N 16E	3	5	Fire Protection, Other, Burn, Hand, Fuel Reduction	155	\$3,875.00	\$0.00
16 3N 16E	3	6	Harvest, Mechanical, Regeneration, Machine, Loblolly	15	\$525.00	\$25,160.55
16 3N 16E	6	4	Regeneration, Artificial, Plant, Hand, Loblolly	42	\$3,780.00	\$0.00
Yearly Totals				384	\$12,870.00	\$42,284.13
2014						

STR	Strata	Stand	Activity	Acre	Est. Cost	Est. Revenue
16 3N 16E	3	6	Site Preparation, Other, Burn, Hand, Cut-Over	15	\$375.00	\$0.00
16 3N 16E	3	6	Site Preparation, Chemical, Broadcast, Aerial, Combination	15	\$1,500.00	\$0.00
16 3N 16E	5	8	Fire Protection, Other, Burn, Hand, Fuel Reduction	118	\$2,950.00	\$0.00
Yearly Totals				148	\$4,825.00	\$0.00

2015

16 3N 16E	2	3	Fire Protection, Other, Burn, Hand, Fuel Reduction	21	\$525.00	\$0.00
16 3N 16E	2	9	Fire Protection, Other, Burn, Hand, Fuel Reduction	18	\$450.00	\$0.00
16 3N 16E	3	5	Harvest, Mechanical, Regeneration, Machine, Loblolly	155	\$5,425.00	\$232,345.00
16 3N 16E	3	6	Regeneration, Artificial, Plant, Hand, Loblolly	15	\$1,500.00	\$0.00
16 3N 16E	5	8	Harvest, Mechanical, 1st Thin, Machine, Loblolly	118	\$4,130.00	\$58,622.40
Yearly Totals				327	\$12,030.00	\$290,967.40

2016

16 3N 16E	1	2	Harvest, Mechanical, 2nd Thin, Machine, Loblolly	37	\$1,295.00	\$12,510.44
16 3N 16E	1	7	Fire Protection, Other, Burn, Hand, Fuel Reduction	31	\$775.00	\$0.00
16 3N 16E	1	10	Harvest, Mechanical, 2nd Thin, Machine, Loblolly	7	\$245.00	\$2,499.56
16 3N 16E	1	11	Harvest, Mechanical, 2nd Thin, Machine, Loblolly	30	\$1,050.00	\$10,712.40
16 3N 16E	1	15	Fire Protection, Other, Burn, Hand, Fuel Reduction	28	\$700.00	\$0.00
16 3N 16E	5	1	Fire Protection, Other, Burn, Hand, Fuel Reduction	79	\$1,975.00	\$0.00
Yearly Totals				212	\$6,040.00	\$25,722.40

2017

16 3N 16E	1	7	Harvest, Mechanical, 2nd Thin, Machine, Loblolly	31	\$1,085.00	\$11,069.48
16 3N 16E	1	15	Harvest, Mechanical, 2nd Thin, Machine, Loblolly	28	\$980.00	\$10,907.68
16 3N 16E	3	5	Site Preparation, Other, Burn, Hand, Cut-Over	155	\$3,875.00	\$0.00
16 3N 16E	3	5	Site Preparation, Chemical, Broadcast, Aerial, Combination	155	\$15,500.00	\$0.00

STR	Strata	Stand	Activity	Acre	Est. Cost	Est. Revenue
16 3N 16E	5	1	Harvest, Mechanical, 1st Thin, Machine, Loblolly	79	\$2,765.00	\$39,247.20
Yearly Totals				448	\$24,205.00	\$61,224.36
2018						
16 3N 16E	1	2	Fire Protection, Other, Burn, Hand, Fuel Reduction	37	\$925.00	\$0.00
16 3N 16E	1	10	Fire Protection, Other, Burn, Hand, Fuel Reduction	7	\$175.00	\$0.00
16 3N 16E	1	11	Fire Protection, Other, Burn, Hand, Fuel Reduction	30	\$750.00	\$0.00
16 3N 16E	2	3	Fire Protection, Other, Burn, Hand, Fuel Reduction	21	\$525.00	\$0.00
16 3N 16E	2	9	Fire Protection, Other, Burn, Hand, Fuel Reduction	18	\$450.00	\$0.00
16 3N 16E	3	5	Regeneration, Artificial, Plant, Machine, Loblolly	155	\$18,600.00	\$0.00
16 3N 16E	5	8	Fire Protection, Other, Burn, Hand, Fuel Reduction	118	\$2,950.00	\$0.00
Yearly Totals				386	\$24,375.00	\$0.00
2021						
16 3N 16E	1	2	Fire Protection, Other, Burn, Hand, Fuel Reduction	37	\$925.00	\$0.00
16 3N 16E	1	7	Fire Protection, Other, Burn, Hand, Fuel Reduction	31	\$775.00	\$0.00
16 3N 16E	1	10	Fire Protection, Other, Burn, Hand, Fuel Reduction	7	\$175.00	\$0.00
16 3N 16E	1	11	Fire Protection, Other, Burn, Hand, Fuel Reduction	30	\$750.00	\$0.00
16 3N 16E	1	15	Fire Protection, Other, Burn, Hand, Fuel Reduction	28	\$700.00	\$0.00
16 3N 16E	2	3	Fire Protection, Other, Burn, Hand, Fuel Reduction	21	\$525.00	\$0.00
16 3N 16E	2	9	Fire Protection, Other, Burn, Hand, Fuel Reduction	18	\$450.00	\$0.00
16 3N 16E	5	1	Fire Protection, Other, Burn, Hand, Fuel Reduction	79	\$1,975.00	\$0.00
16 3N 16E	5	8	Fire Protection, Other, Burn, Hand, Fuel Reduction	118	\$2,950.00	\$0.00
Yearly Totals				369	\$9,225.00	\$0.00
Grand Totals				2,397	\$99,795.00	\$420,198.29