



Vision • Commitment • Pride

FOREST STEWARDSHIP MANAGEMENT PLAN

Prepared For:
Copiah County BOE

Prepared By:
Miles Henderson
MS Forestry Commission

Time Period Covered by This Plan:
2012 - 2021

Date Plan Prepared:
2012-01-18

Plan Type:
Stewardship / Stewardship

This plan was developed in accordance with the rules of the Stewardship program.

Property Name: S16 T9N R6E

TABLE OF CONTENTS

LANDOWNER INFORMATION	3
FORESTER INFORMATION	3
DISCLAIMER	3
INTRODUCTION	3
OBJECTIVES	4
PROPERTY DESCRIPTION	4
GENERAL PROPERTY RECOMMENDATIONS	5
SOIL TYPES	7
STRATA	7
OTHER PLAN ACTIVITIES	11
PLAN MAP	12
PLAN MAP	13
STRATA ACTIVITY SCHEDULE	14

**MISSISSIPPI FORESTRY COMMISSION
FOREST STEWARDSHIP MANAGEMENT PLAN**

LANDOWNER INFORMATION

Name: Copiah County BOE
Mailing Address: 254 West Gallatin St.
City, State, Zip: Hazlehurst, MS 39083
Country: United States of America
Contact Numbers: Home Number:
Office Number: 601-894-1341
Fax Number:

E-mail Address:
Social Security Number (optional):

FORESTER INFORMATION

Name: Miles Henderson , Copiah County Service Forester
Forester Number: 02512
Organization: MS Forestry Commission
Street Address: P.O. Box 229
City, State, Zip: Hazlehurst, MS 39083
Contact Numbers: Office Number: 601-894-1131
Fax Number:
E-mail Address: mhenderson@mfc.state.ms.us

PROPERTY LOCATION

County: Copiah Total Acres: 638 Latitude: -90.61 Longitude: 31.75
Section: 16 Township: 9N Range: 6E

DISCLAIMER

This information was derived from a small sampling of the forest resources. It reflects a statistical estimation that is only intended to be accurate enough for the purposes of making decisions for the short-term management of these resources. These estimations are temporally static. Events and circumstances may occur within the survey area that will physically alter the forest resources and therefore will not be reflected in this plan.

INTRODUCTION

This Forest Stewardship Management Plan will serve as a guide for accomplishing the goals and objectives for your property. In addition to addressing your specific goals and objectives, this plan includes recommendations for maintaining soil and water quality and protecting your forest from insects, disease, and wildfire. Recommendations are based on observation and assessment of the site.

**MISSISSIPPI FORESTRY COMMISSION
FOREST STEWARDSHIP MANAGEMENT PLAN**

OBJECTIVES

Timber Production

The goal is to produce high quality sawtimber. This will be accomplished through reforestation and timber stand improvement practices such as herbicide applications, prescribed burning, thinning at specified intervals, and other silvicultural practices. Forestry Best Management Practices will be implemented to prevent erosion and protect water quality.

Wildlife Management - General

The goal is to provide a diversity of habitats suitable for a variety of game and non-game wildlife species. Habitat management will focus on developing a variety of food, cover, water, and space. This will be accomplished by establishing and maintaining access roads and firelanes, providing openings within the forest, and the management of trees located within the Streamside Management Zone

PROPERTY DESCRIPTION

General Property Information

This section is located in the southwest portion of the Copiah County. Primary access is off Highway 28. There are several access roads into the section, which have locked gates at their entrances. The section has various stand types such as a clear cut, pine plantations, and mature timber. Due to location prescribe burning is very difficult.

Water Resources

A perennial water resource was identified during a reconnaissance of the property. The perennial stream, intermittent stream, and drains will be managed in accordance with Mississippi's Best Management Practices.

Timber Production

The goal is to maximize the production of high quality timber. This will be accomplished through the application of timely thinning and other silvicultural practices designed to enhance timber quality and growth. Forestry Best Management Practices will be implemented to prevent erosion and protect water quality.

Threatened and Endangered Species

No threatened and endangered species were identified during the reconnaissance and evaluation of your property.

Interaction with Surrounding Property

Prescribed practices should be carried out in a manner that will minimize adverse impacts on surrounding properties. Consideration should be given to potential air, water, visual, and other impacts. In addition, practices carried out should have positive effects on the surrounding community such as improved wildlife habitat and soil stabilization.

**MISSISSIPPI FORESTRY COMMISSION
FOREST STEWARDSHIP MANAGEMENT PLAN**

Soils General

Soils were evaluated on the property to determine the suitability of the site for the proposed activities. Forest practices were planned so as to minimize erosion or other adverse effects on the soil.

Archeological and Cultural Resources

A hunting camp exists along Highway 28 as indicated on the attached map. This site will be buffered and designated with yellow paint and flagging on trees around the site. No forest management activities will occur inside of this protected area.

GENERAL PROPERTY RECOMMENDATIONS

Forest Protection

A healthy, vigorously growing stand is the best defense to an attack from a variety of forest insects, plants and pathogens.

Insects and Diseases

Trees are subject to attack from insects and diseases. Different insects and diseases affect trees according to the age, species, and condition of the trees. Planted stands of pines and pure stands of hardwoods are particularly susceptible to attack. Since there are many different insects and diseases, no attempt will be made here to explain all of them. The property should be inspected at least annually for possible signs of insect and disease activity. Some things to look for are:

- Unseasonable leaf fall
- Discoloration of leaves or needles
- Pitch pockets on pine trees
- Heavy defoliation of hardwood leaves
- Groups of three or more dying trees within a stand

This list does not cover all instances of insect or disease attacks. If anything unusual is noticed, report it to a forester. In most cases, insect and disease problems can be controlled if discovered early.

Fire Protection

Your forest should be protected from wildfire at all times. The best way to protect your investment is by establishing and maintaining firebreaks around the property. Guidelines for establishment and maintenance of firebreaks may be found in Mississippi Forestry Commission publication #107, *Mississippi's Best Management Practices*.

**MISSISSIPPI FORESTRY COMMISSION
FOREST STEWARDSHIP MANAGEMENT PLAN**

Grazing

Tree seedlings should be protected from grazing until such time as the terminal bud of the sapling is beyond reach of livestock. Domestic livestock should be denied access to the tree planting area.

Boundary Lines

It is the responsibility of the landowner to ensure that all property lines and boundaries designating areas to receive forestry work are clearly identified and visible to all contractors.

Note: Some forest practices may cause temporary adverse environmental or aesthetic impacts. These practices will only cause short-term adverse impacts where they are installed. Special efforts will be made to minimize adverse effects when carrying out any of the practices. Examples include: site preparation, planting, prescribed fires, firebreak installation and maintenance, road installation and maintenance, pesticide applications and timber harvesting.

Water Quality Protection

The objective of the landowner is to protect, preserve and enhance all water sources on or transecting the property. This can best be achieved by implementation of Best Management Practices in all aspects of the management of the property.

Aesthetics

The goal is to assure that the property is managed in such a way that is aesthetically pleasing to the landowner as well as the community. Activities could include, maintaining buffer strips along the road and adjacent to the home site, planting wildflowers along the road, and trees with attractive fall and spring color along the drive and near the home site.

Ecological Restoration

Ecological restoration is the process of assisting the recovery of an ecosystem that has been degraded, damaged, or destroyed. A reconnaissance of the property has been conducted and no ecological restoration activities are recommended at this time.

Wildlife Mgt. Target Species

The objective of this practice is to provide habitat best suited for the featured or target species. Habitat management will focus on providing food, cover, water, and space to facilitate the target species.

Environmental Education

Environmental educational goals are to provide educational opportunities for children and adults through the development of items such as nature trails with tree identification markers, wildlife viewing areas, picnic areas, parking, public restroom facilities.

Wildlife Management General

The goal is to provide a diversity of habitats suited for a variety of game and non-game wildlife species. Habitat management will focus on providing a variety of food, cover, water, and space. This will be accomplished, in part, by establishing and maintaining

**MISSISSIPPI FORESTRY COMMISSION
FOREST STEWARDSHIP MANAGEMENT PLAN**

access roads and firelanes, providing openings within the forest, and leaving mast producing and den trees.

Timber Management

Timber management goals for this property are to manage timber resources in such a manner as to maximize timber production throughout the life of the stand.

Recreation

According to landowner objectives the recreational use of the property could prove to be an avenue for personal enjoyment or for generating income. An evaluation of your property should be conducted and a plan developed to accomplish your specific goals for recreational activities on your property.

SOIL TYPES

Soils

Providence silt loam (Prb2)(Prc2)- Moderately well drained with 2-8% slope. The erosion hazard is moderate and the runoff is medium. Available water capacity is moderate. The site index for Loblolly Pine and Shumard Oak is 87.

Smithdale sandy loam (SMD)- Is a well drained soil with a slope range of 8-12%. As a result the erosion hazard is severe. Available water capacity is moderate. The site index for Loblolly Pine is 86.

STRATA

Strata 1

Stand Description

Strata 1: Stands 6,16,22,39,40,41,45

Acres: 65

These are Loblolly Pine stands that were open field machine planted in 1993. These stands were first thinned in 2009 and are currently in good health and well stocked.

Stand Recommendations

These stands will be managed to approximately 35-40 years. During this time frame, management activities such as thinning and herbicide applications will be used to maximize growth. At the end of this rotation a final harvest will be conducted and reforestation activities will be completed to return these stands to full production.

Activity Recommendations

Harvest

These stands are scheduled for a second thin in 2015, focusing on removing poor quality, diseased, or poorly formed trees. This will be an operator select thinning,

**MISSISSIPPI FORESTRY COMMISSION
FOREST STEWARDSHIP MANAGEMENT PLAN**

using existing corridors from the first thin to reduce the stocking to 75 square feet of basal area per acre.

Strata 2

Stand Description

Strata 2: Stands 12,13,21,48

Acres: 104

These are sub-merchantable pine stands that were hand planted on a 10' x 6' spacing at a rate of 726 trees per acre in 2004 using genetically improved Loblolly Pine seedlings. These stands are well stocked and healthy.

Stand Recommendations

These stands will be managed to approximately 35-40 years. During this time frame, management activities such as thinning and herbicide applications will be used to maximize growth. At the end of this rotation a final harvest will be conducted and reforestation activities will be completed to return these stands to full production.

Activity Recommendations

Harvest

These stands will be first thinned in 2020. This will be a corridor thin, representing a third or fourth row thin, reducing the stocking to 75 square feet of basal area per acre. This thin will remove about 35% of this stand's volume.

Strata 3

Stand Description

Strata 3: Stands 5,7,11,49

Acres: 99

These stands are permanent Streamside-Management-Zones (SMZs) that were established in 1945. These stands consist of White Oak, Red Oak, hickory, and some scattered Loblolly Pine.

Stand Recommendations

These stands will be managed as permanent Streamside-Management-Zones (SMZs). Mature timber will be harvested as timber sales are completed on adjacent stands. A minimum of 50% crown cover will be maintained to ensure that a quality SMZ is left. This SMZ is vital to reduce soil erosion and to protect water quality.

**MISSISSIPPI FORESTRY COMMISSION
FOREST STEWARDSHIP MANAGEMENT PLAN**

Strata 4

Stand Description

Strata 4: Stands 2,3,4,9,10,23,46

Acres: 143

These mature pine stands with some mixed hardwoods that were established in 1956. These stands are well stocked and in good health.

Strata Recommendations

Stands 3 and 46 (64 acres) are scheduled for a final harvest in 2011, and Stand 4 (57 acres) is scheduled for a final harvest in 2014. Once final harvesting has been completed, reforestation activities will be conducted, including aerial application of herbicides. Second generation Loblolly Pine seedlings will be used to reforest these stands. Stands 9,10, and 23 will be managed with Strata 6. Once established they will be managed on a 35 year rotation.

Activity Recommendations

Harvest

Stand 4 (57 acres) will be final harvested in 2014 along with Strata 4 Stand 19. This type of harvest removes all merchantable timber from the stand. These stands will be artificially reforested after the final harvest.

Stands 9,10, and 23 (22 acres) will be final harvested along with Strata 6 during the next planning period. This type of harvest removes all merchantable timber from the stands. These stands will be artificially reforested after the final harvest.

Site Preparation

Stand 4 will be aerially sprayed with herbicides to control unwanted hardwood competition and herbaceous weeds. This activity will be completed in 2016.

Regeneration

Stand 4 will be hand planted in 2013 using 2nd generation Loblolly pine seedlings. Seedlings will be planted on a 10' x 7' spacing at a rate of 622 trees per acre. A deviation from the recommended planting rates will be limited to plus or minus 40 trees per acre. Planting should be done between December and February. Compliance checks will be completed as these stands are planted to ensure proper planting. A survival study will be completed the following Fall to ensure sufficient stocking. Adverse weather conditions such as prolonged dry or cold periods should be taken into consideration when planting.

**MISSISSIPPI FORESTRY COMMISSION
FOREST STEWARDSHIP MANAGEMENT PLAN**

Strata 5

Stand Description

Strata 5: Stands 15,17,24,29,31,33,43

Acres: 111

These are sub-merchantable pine stands that were hand planted on a 10' x 6' spacing at a rate of 726 trees per acre in 2003 using genetically improved Loblolly Pine seedlings. These stands are well stocked and healthy.

Stand Recommendations

These stands will be managed to approximately 35-40 years. During this time frame, management activities such as thinning and herbicide applications will be used to maximize growth. At the end of this rotation a final harvest will be conducted and reforestation activities will be completed to return these stands to full production.

Activity Recommendations

Harvest

These stands will be first thinned in 2019. This will be a corridor thin, representing a third or fourth row thin, reducing the stocking to 75 square feet of basal area per acre. This thin will remove about 35% of this strata's volume.

Strata 6

Stand Description

Strata 6: Stands 8,14,18,20,25,34

Acres: 85

These are Loblolly Pine stands that were open field machine planted in 1987. These stands were second thinned in 2009 and are currently in good health and well stocked.

Stand Recommendations

These stands will be managed to approximately 35-40 years. During this time frame management activities such as thinning and herbicide applications will be used to maximize growth. At the end of this rotation a final harvest will be conducted and reforestation activities will be completed to return these stands to full production.

Activity Recommendations

Harvest

A third thin is scheduled in 2016, focusing on removing poor quality, diseased, or poorly formed trees. This will be an operator select thinning, using existing corridors from the previous thins to reduce the stocking to 75 square feet of basal area per acre.

**MISSISSIPPI FORESTRY COMMISSION
FOREST STEWARDSHIP MANAGEMENT PLAN**

Strata 7

Stand Description

Strata 7: Stands 3, 46

Acres: 64

These stands were final harvested in 2011. These stands are scheduled for reforestation in 2012 using 2nd generation Loblolly Pine seedlings.

Stand Recommendations

These stands will be managed to approximately 35-40 years. During this time frame, management activities such as thinning and herbicide applications will be used to maximize growth. At the end of this rotation a final harvest will be conducted and reforestation activities will be completed to return these stands to full production

Activity Recommendations

Vegetation Control

Stands 3 and 46 will be aerially sprayed with herbicides to control unwanted hardwood competition and herbaceous weeds. This activity will be completed in 2011.

Regeneration

Stands 3 and 46 will be hand planted in 2012 using 2nd generation Loblolly Pine seedlings. Seedlings will be planted on a 10' x 7' spacing at a rate of 622 trees per acre. A deviation from the recommended planting rates will be limited to plus or minus 40 trees per acre. Planting should be done between December and February. Compliance checks will be completed as these stands are planted to ensure proper planting. A survival study will be completed the following Fall to ensure sufficient stocking. Adverse weather conditions such as prolonged dry or cold periods should be taken into consideration when planting.

OTHER PLAN ACTIVITIES

Property Activities

Activity Recommendations

Routine inspections and general maintenance of the roads, firelanes, and boundary lines will ensure overall appearance and aesthetics of the property.

SEC 16 TWN 9N RGE 6E



Copiah Board of Education

SEC 16; TWN 9N; RGE 6E
2012 to 2021
637.70 Acres

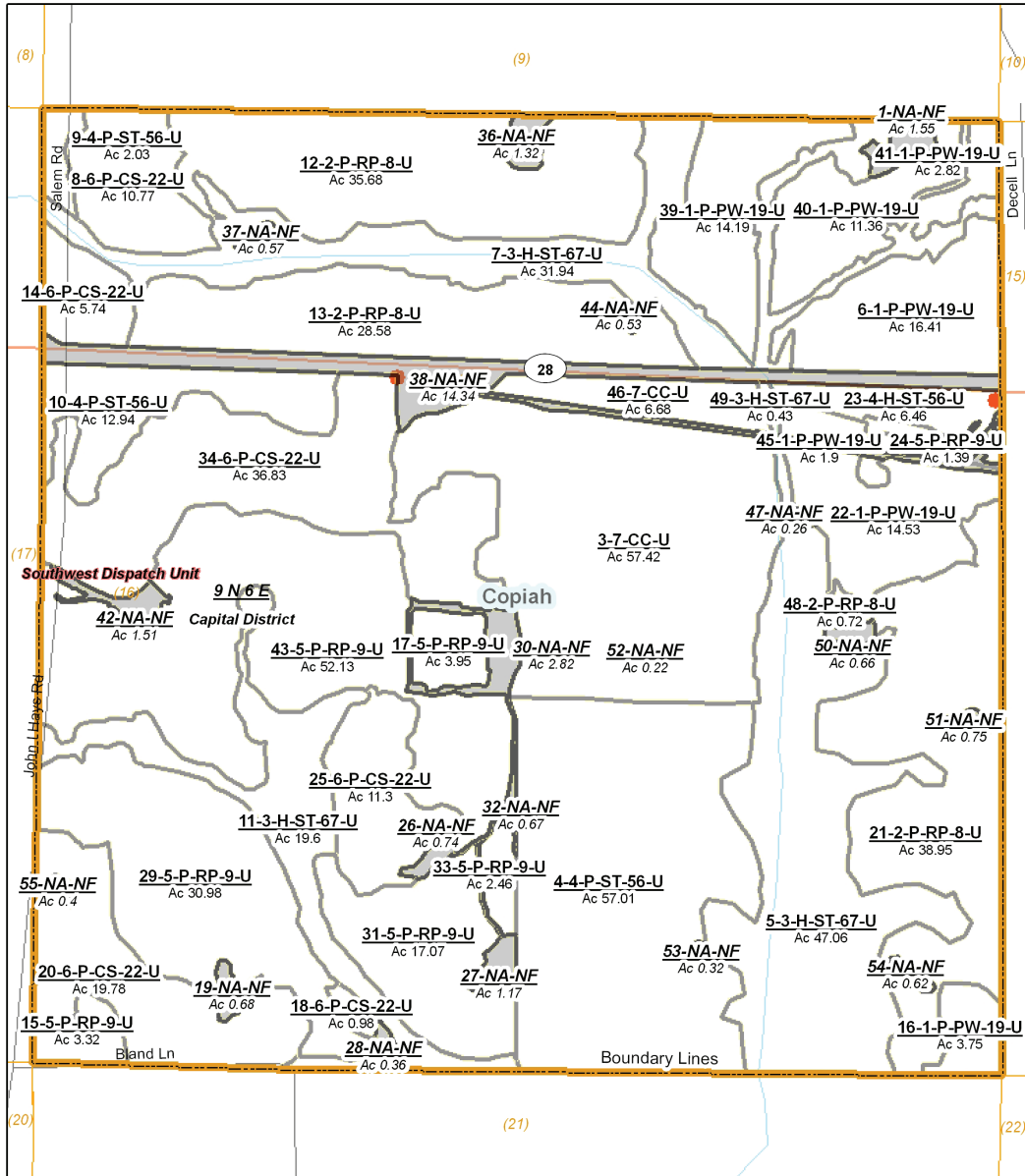

(02/17/2012)

SEC 16 TWN 9N RGE 6E



SEC 16; TWN 9N; RGE 6E

Property

- Property (1)

Category 1: Stands

- Reproduction (11)
- Sawtimber (9)
- Clear Cut (2)
- Pulpwood (7)
- Chip-n-Saw (6)

Category 3: Non-Forest Stands

- Non-Forest (20)

Structures

- Camp House (1)

Other

- Locked (2)

Boundary Lines

- Property (1)

Management Compartment

- Site Preparation (2)

MFC Basemap

County Boundary

- County Boundary (1)

Quadrangle Grid

- USGS Quad (2)

PLS Townships

- PLS Townships (1)

Survey Districts

- District 4 (1)

Blockgroup (Census 2000)

- Blockgroup (Census 2000) (1)

Block (Census 2000)

- Block (Census 2000) (5)

Tract/BNA (Census 2000)

- Tract/BNA (Census 2000) (1)

County Roads

- County Roads (3)

US/State Highways

- State Highway (1)

School Sections

- School Sections (1)

Public School Districts

- COPIAH COUNTY SCHOOL DISTRICT (1)

US Congressional District

- US Cong Dist #2 (1)

MS Senate

- 36 (1)

MS House

- 76 (1)

Intermittent Streams

- Intermittent Streams (2)

Hydrologic Units (Basins)

- HOMOCHITTO RIVER (1)

Historic Forest Boundary

- Shortleaf/Longleaf Pine-Upland Hardwood-Loblolly Pine (1)

MS Forest Habitat

- SOUTHERN LOESSIAL LOAM HILLS-RUGGED TOPO (1)

Physiographic Region

- SOUTH CENTRAL HILLS (1)

Soil Associations

- providence-smithdale-saffell (1)

Surface Geology

- CITRONELLE (1)

MFC Districts

- MFC Districts (1)

MFC Dispatch Units

- MFC Dispatch Units (1)

MS Outline

- MS Outline (1)

Stand Activity Summary for
Copiah County BOE
16 9N 6E

Filters Applied: County: Copiah
Client Class: School Trust Land
District: Capital District
Client: Copiah County BOE
STR: 16 9N 6E
Activity:
Year: 2012 Through 2021

STR	Strata	Stand	Activity	Acre	Est. Cost	Est. Revenue	
2012							
16 9N 6E	7	3	Regeneration, Artificial, Plant, Hand, Loblolly	57	\$4,560.00	\$0.00	
16 9N 6E	7	3	Site Preparation, Chemical, Broadcast, Aerial, Combination	57	\$4,275.00	\$0.00	
16 9N 6E	7	46	Regeneration, Artificial, Plant, Hand, Loblolly	7	\$595.00	\$0.00	
16 9N 6E	7	46	Site Preparation, Chemical, Broadcast, Aerial, Combination	7	\$525.00	\$0.00	
				Yearly Totals	128	\$9,955.00	\$0.00
2014							
16 9N 6E	4	4	Harvest, Mechanical, Final, Machine, Loblolly	57	\$1,995.00	\$127,224.00	
				Yearly Totals	57	\$1,995.00	\$127,224.00
2015							
16 9N 6E	1	6	Harvest, Mechanical, 2nd Thin, Machine, Loblolly	16	\$574.35	\$7,384.50	
16 9N 6E	1	16	Harvest, Mechanical, 2nd Thin, Machine, Loblolly	4	\$140.00	\$1,800.00	
16 9N 6E	1	22	Harvest, Mechanical, 2nd Thin, Machine, Loblolly	15	\$508.55	\$6,538.50	
16 9N 6E	1	39	Harvest, Mechanical, 2nd Thin, Machine, Loblolly	14	\$496.65	\$6,385.50	
16 9N 6E	1	40	Harvest, Mechanical, 2nd Thin, Machine, Loblolly	11	\$397.60	\$5,112.00	
16 9N 6E	1	41	Harvest, Mechanical, 2nd Thin, Machine, Loblolly	3	\$98.70	\$1,269.00	
16 9N 6E	1	45	Harvest, Mechanical, 2nd Thin, Machine, Loblolly	2	\$66.50	\$855.00	
				Yearly Totals	65	\$2,282.35	\$29,344.50
2016							

STR	Strata	Stand	Activity	Acre	Est. Cost	Est. Revenue
16 9N 6E	4	4	Site Preparation, Chemical, Broadcast, Aerial, Combination	57	\$4,275.00	\$0.00
16 9N 6E	4	4	Regeneration, Artificial, Plant, Hand, Loblolly	57	\$4,845.85	\$0.00
16 9N 6E	6	8	Harvest, Mechanical, Thin, Machine, Loblolly	11	\$385.00	\$6,710.00
16 9N 6E	6	14	Harvest, Mechanical, Thin, Machine, Loblolly	6	\$200.90	\$3,501.40
16 9N 6E	6	18	Harvest, Mechanical, Thin, Machine, Loblolly	1	\$34.30	\$597.80
16 9N 6E	6	20	Harvest, Mechanical, Thin, Machine, Loblolly	20	\$692.30	\$12,065.80
16 9N 6E	6	25	Harvest, Mechanical, Thin, Machine, Loblolly	11	\$395.50	\$6,893.00
16 9N 6E	6	34	Harvest, Mechanical, Thin, Machine, Loblolly	37	\$1,289.05	\$22,466.30

Yearly Totals				200	\$12,117.90	\$52,234.30
---------------	--	--	--	-----	-------------	-------------

2019

16 9N 6E	5	15	Harvest, Mechanical, 1st Thin, Machine, Loblolly	3	\$105.00	\$1,020.00
16 9N 6E	5	17	Harvest, Mechanical, 1st Thin, Machine, Loblolly	4	\$138.25	\$1,343.00
16 9N 6E	5	24	Harvest, Mechanical, 1st Thin, Machine, Loblolly	1	\$48.65	\$472.60
16 9N 6E	5	29	Harvest, Mechanical, 1st Thin, Machine, Loblolly	31	\$1,084.30	\$10,533.20
16 9N 6E	5	31	Harvest, Mechanical, 1st Thin, Machine, Loblolly	17	\$597.45	\$5,803.80
16 9N 6E	5	33	Harvest, Mechanical, 1st Thin, Machine, Loblolly	2	\$86.10	\$836.40
16 9N 6E	5	43	Harvest, Mechanical, 1st Thin, Machine, Loblolly	52	\$1,824.55	\$17,724.20

Yearly Totals				111	\$3,884.30	\$37,733.20
---------------	--	--	--	-----	------------	-------------

2020

16 9N 6E	2	12	Harvest, Mechanical, 1st Thin, Machine, Loblolly	36	\$1,260.00	\$12,240.00
16 9N 6E	2	13	Harvest, Mechanical, 1st Thin, Machine, Loblolly	29	\$1,000.30	\$9,717.20
16 9N 6E	2	21	Harvest, Mechanical, 1st Thin, Machine, Loblolly	39	\$1,363.25	\$13,243.00
16 9N 6E	2	48	Harvest, Mechanical, 1st Thin, Machine, Loblolly	1	\$25.20	\$244.80

Yearly Totals				104	\$3,648.75	\$35,445.00
---------------	--	--	--	-----	------------	-------------

STR	Strata	Stand	Activity	Acre	Est. Cost	Est. Revenue	
2021							
16 9N 6E	5	24	Vegetation Control, Chemical, Broadcast, Aerial, Woody	1	\$90.35	\$0.00	
				Yearly Totals	1	\$90.35	\$0.00
				Grand Totals	666	\$33,973.65	\$281,981.00