



Vision • Commitment • Pride

# FOREST STEWARDSHIP MANAGEMENT PLAN

Prepared For:  
Greene County BOE

Prepared By:  
James Shumpert  
MS Forestry Commission

Time Period Covered by This Plan:  
2012 - 2021

Date Plan Prepared:  
2012-02-17

Plan Type:  
Stewardship / Stewardship

This plan was developed in accordance with the rules of the Stewardship program.

**Property Name: S16 - T4N - R8W**

MISSISSIPPI FOREST STEWARDSHIP PROGRAM

## TABLE OF CONTENTS

LANDOWNER INFORMATION .....	3
FORESTER INFORMATION .....	3
DISCLAIMER .....	3
INTRODUCTION .....	3
OBJECTIVES .....	4
PROPERTY DESCRIPTION .....	4
GENERAL PROPERTY RECOMMENDATIONS .....	5
STANDS .....	7
OTHER PLAN ACTIVITIES .....	15
PLAN MAP .....	16
PLAN MAP .....	17
PLAN MAP .....	18
PLAN MAP .....	19
STAND ACTIVITY SCHEDULE .....	20

**MISSISSIPPI FORESTRY COMMISSION  
FOREST STEWARDSHIP MANAGEMENT PLAN**

**LANDOWNER INFORMATION**

Name: Greene County BOE  
Mailing Address: 528 West Oak Street  
City, State, Zip: Leakesville, MS 39451  
Country: United States of America  
Contact Numbers: Home Number:  
Office Number: 601-394-2364  
Fax Number: 601-394-5542  
  
E-mail Address:  
Social Security Number (optional): 646000392

**FORESTER INFORMATION**

Name: James Shumpert , Service Forester  
Forester Number: 02470  
Organization: MS Forestry Commission  
Street Address: P.O. Box 428  
City, State, Zip: Leakesville , MS 39451  
Contact Numbers: Office Number: 601-394-2785  
Fax Number: 601-947-2947  
  
E-mail Address: jshumpert@mfc.state.ms.us

**PROPERTY LOCATION**

County: Greene    Total Acres: 652    Latitude: -88.8    Longitude: 31.31  
Section: 16    Township: 4N    Range: 8W

**DISCLAIMER**

This information was derived from a small sampling of the forest resources. It reflects a statistical estimation that is only intended to be accurate enough for the purposes of making decisions for the short-term management of these resources. These estimations are temporally static. Events and circumstances may occur within the survey area that will physically alter the forest resources and therefore will not be reflected in this plan.

**INTRODUCTION**

This Forest Stewardship Management Plan will serve as a guide for accomplishing the goals and objectives for your property. In addition to addressing your specific goals and objectives, this plan includes recommendations for maintaining soil and water quality and protecting your forest from insects, disease, and wildfire. Recommendations are based on observation and assessment of the site.

**MISSISSIPPI FORESTRY COMMISSION  
FOREST STEWARDSHIP MANAGEMENT PLAN**

**OBJECTIVES**

*Timber Production*

The goal is to produce high quality sawtimber. This will be accomplished through reforestation and timber stand improvement practices such as herbicide applications, prescribed burning, thinning at specified intervals, and other silvicultural practices. Forestry Best Management Practices will be implemented to prevent erosion and protect water quality.

*Wildlife Management - General*

The goal is to provide a diversity of habitats suitable for a variety of game and non-game wildlife species. Habitat management will focus on developing a variety of food, cover, water, and space. This will be accomplished by establishing and maintaining access roads and firelanes, providing openings within the forest, and the management of trees located within the Streamside Management Zone.

**PROPERTY DESCRIPTION**

*General Property Information*

The section is located in the Freeman Town Community of Greene County and is accessed by Boykin Creek Road, Oil Well Road, and Sumrall Road.

The timber stands on this section are comprised of natural stands of mixed loblolly, slash, and longleaf pine sawtimber, slash pine pulpwood plantations, and hardwood drains. These areas represent a total of  $\pm$  636 forested acres in timber management. In addition, this section has  $\pm$  16 non-forested acres with no forest management activities planned.

The soils on the section are primarily sandy loam in nature.

The section has a bad dumping problem and there is a large dumping area along Boykin Creek Road. Also, from time to time, someone will set this dump on fire which escapes into the woods becoming a wildfire and burning numerous acres on the section.

*Water Resources*

There are several drains that head up in this section and drain into either Boykin Creek to the east or into Gaines Creek to the west. Perennial and intermittent streams and drains identified will be managed in accordance with Mississippi's Best Management Practices.

*Archeological and Cultural Resources*

These areas can range from churches, old cemeteries, or Indian mounds to old home sites or other areas of historical significance.

No Archeological or Cultural resources were identified during a reconnaissance of the property. However, if Archeological or Cultural resources are discovered anytime on the property special managements measures will be applied immediately in order preserve these sensitive areas.

**MISSISSIPPI FORESTRY COMMISSION  
FOREST STEWARDSHIP MANAGEMENT PLAN**

*Timber Production*

The goal is to maximize the production of high quality timber. This will be accomplished through the application of timely thinning and other silvicultural practices designed to enhance timber quality and growth. Forestry Best Management Practices will be implemented to prevent erosion and protect water quality.

*Threatened and Endangered Species*

No threatened and endangered species were identified during the reconnaissance and evaluation of your property.

*Interaction with Surrounding Property*

Prescribed practices should be carried out in a manner that will minimize adverse impacts on surrounding properties. Consideration should be given to potential air, water, visual, and other impacts. In addition, practices carried out should have positive effects on the surrounding community such as improved wildlife habitat and soil stabilization.

*Soils General*

Soils were evaluated on the property to determine the suitability of the site for the proposed activities. Forest practices were planned so as to minimize erosion or other adverse effects on the soil. The soils on this section are primarily sandy loam in nature.

## **GENERAL PROPERTY RECOMMENDATIONS**

*Forest Protection*

A healthy vigorously growing stand is the best defense to an attack from a variety of forest insects, plants, and pathogens.

*Insects and Diseases*

Trees are subject to attack from insects and diseases. Different insects and diseases affect trees according to the age, species, and condition of the trees. Planted stands of pines and pure stands of hardwoods are particularly susceptible to attack. Since there are many different insects and diseases, no attempt will be made here to explain all of them. The property should be inspected at least annually for possible signs of insect and disease activity. Some things to look for are:

- Unseasonable leaf fall
- Discoloration of leaves or needles
- Pitch pockets on pine trees
- Heavy defoliation of hardwood leaves
- Groups of three or more dying trees within a stand

This list does not cover all instances of insect or disease attacks. If anything unusual is noticed, report it to a forester. In most cases, insect and disease problems can be controlled if discovered early.

# MISSISSIPPI FORESTRY COMMISSION

## FOREST STEWARDSHIP MANAGEMENT PLAN

### Fire Protection

Your forest should be protected from wildfire at all times. The best way to protect your investment is by establishing and maintaining firebreaks around the property. Guidelines for establishment and maintenance of firebreaks may be found in Mississippi Forestry Commission publication #107, *Mississippi's Best Management Practices*.

### Grazing

Tree seedlings should be protected from grazing until such time as the terminal bud of the sapling is beyond reach of livestock. Domestic livestock should be denied access to the tree planting area.

### Boundary Lines

It is the responsibility of the landowner to ensure that all property lines and boundaries designating areas to receive forestry work are clearly identified and visible to all contractors.

**Note:** Some forest practices may cause temporary adverse environmental or aesthetic impacts. These practices will only cause short-term adverse impacts where they are installed. Special efforts will be made to minimize adverse effects when carrying out any of the practices. Examples include: site preparation, planting, prescribed fires, firebreak installation and maintenance, road installation and maintenance, pesticide applications and timber harvesting.

### Cogongrass Control

Cogongrass is present on every School Trust section in Greene County. While it appears that total eradication of this invasive species is impossible, every precaution must be made to prevent further spread. Treatment costs for cogongrass control are not addressed in the activities portion of this plan due to the uncertainty of the extent of cogongrass infestation on each section. An assessment is now being made to determine the best way to treat this problem.

### *Water Quality Protection*

The objective of the landowner is to protect, preserve and enhance all water sources on or transecting the property. This can best be achieved by implementation of Best Management Practices in all aspects of the management of the property.

### *Aesthetics*

The goal is to assure that the property is managed in such a way that is aesthetically pleasing to the landowner as well as the community.

### *Ecological Restoration*

Ecological restoration is the process of assisting the recovery of an ecosystem that has been degraded, damaged, or destroyed. A reconnaissance of the property has been conducted and no ecological restoration activities are recommended at this time.

**MISSISSIPPI FORESTRY COMMISSION  
FOREST STEWARDSHIP MANAGEMENT PLAN**

*Timber Management*

Timber management goals for this property are to manage timber resources in such a manner as to maximize timber production throughout the life of the stand.

*Recreation*

According to landowner objectives the recreational use of the property could prove to be an avenue for personal enjoyment or for generating income. An evaluation of your property should be conducted and a plan developed to accomplish your specific goals for recreational activities on your property.

## **STANDS**

*1-3-P-ST-45-U (94 Acres)*

**Stand Description**

The stand consists of mixture of natural slash, longleaf, and loblolly pine sawtimber with some scattered red oaks, turkey oaks, dogwoods, and other various hardwood species that was originated in 1966. The stand has an average DBH of 10, with a basal area of 119, and 140 trees per acre. The soils on the site are primarily sandy loam in nature.

**Stand Recommendations**

The stand is recommended to have a final harvest conducted on it in 2017. Once, all of the merchantable timber has been removed the stand needs to have a chemical site preparation, and planted with loblolly pine seedlings in 2019.

**Activity Recommendations**

**Harvest**

The stand should have a final harvest conducted on it in 2017 and remove all merchantable timber.

**Site Preparation**

The stand is recommended to have an aerial application of herbicides applied in the summer prior to replanting. The application of herbicide will reduce the amount of competing vegetation on the stand, which will provide an establishment period for the pine seedling that will be planted the following winter.

**Site Preparation**

The stand should be burned six to eight weeks after the chemical application has been applied to reduce debris that may impede tree planting.

**Regeneration**

The site will be planted during January of 2019 with genetically improved loblolly pine seedlings on a 6 by 12 foot spacing with a target of 605 trees per acre.

**MISSISSIPPI FORESTRY COMMISSION  
FOREST STEWARDSHIP MANAGEMENT PLAN**

*7-1-M-ST-45-B (2 Acres)*

**Stand Description**

The stand is made up of small creeks and drains, which will be managed as a Streamside Management Zone (SMZ). The timber type is primarily hardwood pulpwood with some scattered slash pine sawtimber mixed in. The primary species of hardwood are sweet bay, black gum, red maple, yellow poplar, beech, magnolia, and water oak.

**Stand Recommendations**

The stand should have all merchantable pine that is over mature, damaged, suppress, and diseased marked to be remove when the adjacent stand's harvest is conduct. The basal area will be reduce to no lower than 55 so it will open the tree canopy and increase the diameter and height of the remaining timber. All Mississippi's Best Management Practices (BMP's) will be followed when harvest is conducted.

The stand is recommended to be managed as a corridor to provide wildlife species food and cover, and to preserve water quality.

*8-1-M-ST-45-B (17 Acres)*

**Stand Description**

The stand is made up of small creeks and drains, which will be managed as a Streamside Management Zone (SMZ). The timber type is primarily hardwood pulpwood with some scattered slash pine sawtimber mixed in. The primary species of hardwood are sweet bay, black gum, red maple, yellow poplar, beech, magnolia, and water oak.

**Stand Recommendations**

The stand should have all merchantable pine that is over mature, damaged, suppress, and diseased marked to be remove when the adjacent stand's harvest is conduct. The basal area will be reduce to no lower than 55 so it will open the tree canopy and increase the diameter and height of the remaining timber. All Mississippi's Best Management Practices (BMP's) will be followed when harvest is conducted.

The stand is recommended to be managed as a corridor to provide wildlife species food and cover, and to preserve water quality.

*9-1-M-ST-45-B (2 Acres)*

**Stand Description**

The stand is made up of small creeks and drains, which will be managed as a Streamside Management Zone (SMZ). The timber type is primarily hardwood pulpwood with some



**MISSISSIPPI FORESTRY COMMISSION  
FOREST STEWARDSHIP MANAGEMENT PLAN**

scattered slash pine sawtimber mixed in. The primary species of hardwood are sweet bay, black gum, red maple, yellow poplar, beech, magnolia, and water oak.

**Stand Recommendations**

The stand should have all merchantable pine that is over mature, damaged, suppress, and diseased marked to be remove when the adjacent stand's harvest is conduct. The basal area will be reduce to no lower than 55 so it will open the tree canopy and increase the diameter and height of the remaining timber. All Mississippi's Best Management Practices (BMP's) will be followed when harvest is conducted.

The stand is recommended to be managed as a corridor to provide wildlife species food and cover, and to preserve water quality.

*10-3-P-ST-45-U (63 Acres)*

**Stand Description**

The stand consists of mixture of natural slash, longleaf, and loblolly pine sawtimber with some scattered red oaks, turkey oaks, dogwoods, and other various hardwood species that was originated in 1966. The stand has an average DBH of 10, with a basal area of 119, and 140 trees per acre. The soils on the site are primarily sandy loam in nature.

**Stand Recommendations**

The stand is recommended to have a final harvest conducted on it in 2021. Once, all of the merchantable timber has been removed the stand needs to have a chemical site preparation, and planted with loblolly pine seedlings in 2023.

**Activity Recommendations**

**Harvest**

The stand should have a final harvest conducted on it in 2021 and remove all merchantable timber.

*11-3-P-ST-45-U (4 Acres)*

**Stand Description**

The stand consists of mixture of natural slash, longleaf, and loblolly pine sawtimber with some scattered red oaks, turkey oaks, dogwoods, and other various hardwood species that was originated in 1966. The stand has an average DBH of 10, with a basal area of 119, and 140 trees per acre. The soils on the site are primarily sandy loam in nature.

**MISSISSIPPI FORESTRY COMMISSION  
FOREST STEWARDSHIP MANAGEMENT PLAN**

**Stand Recommendations**

The stand is recommended to have a final harvest conducted on it in 2020. Once, all of the merchantable timber has been removed the stand needs to have a chemical site preparation, and planted with loblolly pine seedlings in 2022.

**Activity Recommendations**

**Harvest**

The stand should have a final harvest conducted on it in 2020 and remove all merchantable timber.

*12-2-P-PW-25-U (151 Acres)*

**Stand Description**

The stand consists of slash pine that was planted in 1984; however, there was also some planted loblolly and direct seeded longleaf mixed in. The product that is mostly found on the site is in the pulpwood size class; there are also some scattered chip-n-saw trees throughout the stand. The stands average DBH is 7, with a basal area of 77, and 236 trees per acre.

**Stand Recommendations**

The stand is recommended to be thinned in 2015. A prescribe burn should be carried out every three or four years to control undesirable vegetation and hardwood species.

**Activity Recommendations**

**Harvest**

The stand should be thinned in 2015 to reduce the basal area to 60 and leave about 160 trees per acre.

**Fire Protection**

A prescribed fire is recommended for this site in order to reduce fuel loading and the potential for a wildfire to occur. A prescribed burning plan must be developed and followed in the application of the burn. Because of equipment, personnel and weather requirements, the application of a prescribed fire is limited to only those days that meet requirements of the burning plan. A certified prescribed burning manager should be employed to conduct the burn. The Mississippi Forestry Commission (on a limited basis) and other certified prescribed burning vendors are available to conduct prescribed burning.

The stand is recommended to have a prescribe burn conducted in 2017 to reduce the amount of debris, undesirable vegetation, and hardwood completion.

*13-1-M-ST-45-B (2 Acres)*

**MISSISSIPPI FORESTRY COMMISSION  
FOREST STEWARDSHIP MANAGEMENT PLAN**

**Stand Description**

The stand is made up of small creeks and drains, which will be managed as a Streamside Management Zone (SMZ). The timber type is primarily hardwood pulpwood with some scattered slash pine sawtimber mixed in. The primary species of hardwood are sweet bay, black gum, red maple, yellow poplar, beech, magnolia, and water oak.

**Stand Recommendations**

The stand should have all merchantable pine that is over mature, damaged, suppress, and diseased marked to be remove when the adjacent stand's harvest is conduct. The basal area will be reduce to no lower than 55 so it will open the tree canopy and increase the diameter and height of the remaining timber. All Mississippi's Best Management Practices (BMP's) will be followed when harvest is conducted.

The stand is recommended to be managed as a corridor to provide wildlife species food and cover, and to preserve water quality.

*14-3-P-ST-45-U (62 Acres)*

**Stand Description**

The stand consists of mixture of natural slash, longleaf, and loblolly pine sawtimber with some scattered red oaks, turkey oaks, dogwoods, and other various hardwood species that was originated in 1966. The stand has an average DBH of 10, with a basal area of 119, and 140 trees per acre. The soils on the site are primarily sandy loam in nature.

**Stand Recommendations**

The stand is recommended to have a final harvest conducted on it in 2021. Once, all of the merchantable timber has been removed the stand needs to have a chemical site preparation, and planted with loblolly pine seedlings in 2023.

**Activity Recommendations**

**Harvest**

The stand should have a final harvest conducted on it in 2021 and remove all merchantable timber.

*15-1-M-ST-45-B (7 Acres)*

**Stand Description**

The stand is made up of small creeks and drains, which will be managed as a Streamside Management Zone (SMZ). The timber type is primarily hardwood pulpwood with some scattered slash pine sawtimber mixed in. The primary species of hardwood are sweet bay, black gum, red maple, yellow poplar, beech, magnolia, and water oak.

**MISSISSIPPI FORESTRY COMMISSION  
FOREST STEWARDSHIP MANAGEMENT PLAN**

**Stand Recommendations**

The stand should have all merchantable pine that is over mature, damaged, suppress, and diseased marked to be remove when the adjacent stand's harvest is conduct. The basal area will be reduce to no lower than 55 so it will open the tree canopy and increase the diameter and height of the remaining timber. All Mississippi's Best Management Practices (BMP's) will be followed when harvest is conducted.

The stand is recommended to be managed as a corridor to provide wildlife species food and cover, and to preserve water quality.

*16-1-M-ST-45-B (15 Acres)*

**Stand Description**

The stand is made up of small creeks and drains, which will be managed as a Streamside Management Zone (SMZ).The timber type is primarily hardwood pulpwood with some scattered slash pine sawtimber mixed in. The primary species of hardwood are sweet bay, black gum, red maple, yellow poplar, beech, magnolia, and water oak.

**Stand Recommendations**

The stand should have all merchantable pine that is over mature, damaged, suppress, and diseased marked to be remove when the adjacent stand's harvest is conduct. The basal area will be reduce to no lower than 55 so it will open the tree canopy and increase the diameter and height of the remaining timber. All Mississippi's Best Management Practices (BMP's) will be followed when harvest is conducted.

The stand is recommended to be managed as a corridor to provide wildlife species food and cover, and to preserve water quality.

*17-1-M-ST-45-B (3 Acres)*

**Stand Description**

The stand is made up of small creeks and drains, which will be managed as a Streamside Management Zone (SMZ).The timber type is primarily hardwood pulpwood with some scattered slash pine sawtimber mixed in. The primary species of hardwood are sweet bay, black gum, red maple, yellow poplar, beech, magnolia, and water oak.

**Stand Recommendations**

The stand should have all merchantable pine that is over mature, damaged, suppress, and diseased marked to be remove when the adjacent stand's harvest is conduct. The basal area will be reduce to no lower than 55 so it will open the tree canopy and increase the diameter and height of the remaining timber. All Mississippi's Best Management Practices (BMP's) will be followed when harvest is conducted.

**MISSISSIPPI FORESTRY COMMISSION  
FOREST STEWARDSHIP MANAGEMENT PLAN**

The stand is recommended to be managed as a corridor to provide wildlife species food and cover, and to preserve water quality.

*18-1-M-ST-45-B (12 Acres)*

**Stand Description**

The stand is made up of small creeks and drains, which will be managed as a Streamside Management Zone (SMZ). The timber type is primarily hardwood pulpwood with some scattered slash pine sawtimber mixed in. The primary species of hardwood are sweet bay, black gum, red maple, yellow poplar, beech, magnolia, and water oak.

**Stand Recommendations**

The stand should have all merchantable pine that is over mature, damaged, suppress, and diseased marked to be remove when the adjacent stand's harvest is conduct. The basal area will be reduce to no lower than 55 so it will open the tree canopy and increase the diameter and height of the remaining timber. All Mississippi's Best Management Practices (BMP's) will be followed when harvest is conducted.

The stand is recommended to be managed as a corridor to provide wildlife species food and cover, and to preserve water quality.

*19-1-M-ST-45-B (6 Acres)*

**Stand Description**

The stand is made up of small creeks and drains, which will be managed as a Streamside Management Zone (SMZ). The timber type is primarily hardwood pulpwood with some scattered slash pine sawtimber mixed in. The primary species of hardwood are sweet bay, black gum, red maple, yellow poplar, beech, magnolia, and water oak.

**Stand Recommendations**

The stand should have all merchantable pine that is over mature, damaged, suppress, and diseased marked to be remove when the adjacent stand's harvest is conduct. The basal area will be reduce to no lower than 55 so it will open the tree canopy and increase the diameter and height of the remaining timber. All Mississippi's Best Management Practices (BMP's) will be followed when harvest is conducted.

The stand is recommended to be managed as a corridor to provide wildlife species food and cover, and to preserve water quality.

*21-4-P-ST-45-U (44 Acres)*

**MISSISSIPPI FORESTRY COMMISSION  
FOREST STEWARDSHIP MANAGEMENT PLAN**

**Stand Description**

The stand consists of mixture of natural slash, longleaf, and loblolly pine sawtimber with some scattered red oaks, turkey oaks, dogwoods, and other various hardwood species that was originated in 1966. The stand has an average DBH of 10, with a basal area of 119, and 140 trees per acre. The soils on the site are primarily sandy loam in nature.

**Stand Recommendations**

The stand is recommended to have a final harvest conducted on it in 2016. Once, all of the merchantable timber has been removed the stand needs to have a chemical site preparation, and planted with either longleaf or loblolly pine seedlings in 2018.

**Activity Recommendations**

**Harvest**

The stand should have a final harvest conducted on it in 2016 and remove all merchantable timber.

**Site Preparation**

The stand is recommended to have an aerial application of herbicides applied in the summer prior to replanting. The application of herbicide will reduce the amount of competing vegetation on the stand, which will provide an establishment period for the pine seedling that will be planted the following winter.

**Site Preparation**

The stand should be burned six to eight weeks after the chemical application has been applied to reduce debris that may impede tree planting.

**Regeneration**

The site will be planted during January of 2018 with genetically improved loblolly or containerized longleaf pine seedlings on a 6 by 12 foot spacing with a target of 605 trees per acre.

*20-3-P-ST-45-U (153 Acres)*

**Stand Description**

The stand consists of mixture of natural slash, longleaf, and loblolly pine sawtimber with some scattered red oaks, turkey oaks, dogwoods, and other various hardwood species that was originated in 1966. The stand has an average DBH of 10, with a basal area of 119, and 140 trees per acre. The soils on the site are primarily sandy loam in nature.

**MISSISSIPPI FORESTRY COMMISSION  
FOREST STEWARDSHIP MANAGEMENT PLAN**

**Stand Recommendations**

The stand is recommended to have a final harvest conducted on it in 2020. Once, all of the merchantable timber has been removed the stand needs to have a chemical site preparation, and planted with loblolly pine seedlings in 2022.

**Activity Recommendations**

**Harvest**

The stand should have a final harvest conducted on it in 2020 and remove all merchantable timber.

**OTHER PLAN ACTIVITIES**

*Boundary Lines*

**Line Recommendations**

The section's boundary lines are well established and recommended to be maintained on a five year rotation.

**Activity Recommendations**

**Property Activities**

The boundary line will be painted in 2016, 2021, and will be maintained on a 5 year cycle. Routine inspections and general maintenance of the boundary lines will ensure overall appearance and aesthetics of the property.



Map 1



**Section 16, Township 04 North, Range 08 West**

Boykin Creek Road  
2012 to 2021  
652.18 Acres

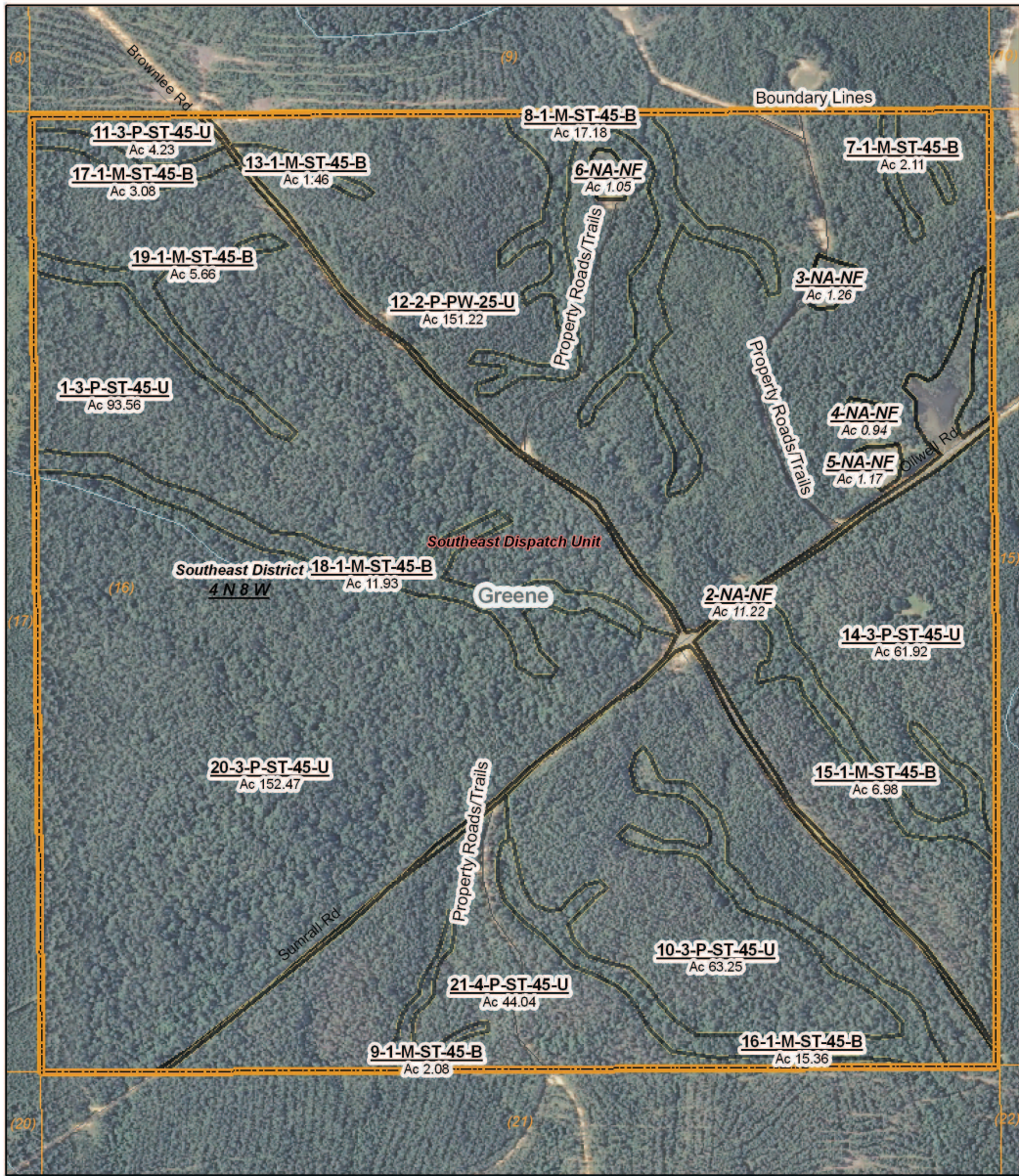

(09/22/2011)





Map 2



**Section 16, Township 04 North, Range 08 West**

Boykin Creek Road  
2012 to 2021  
652.18 Acres

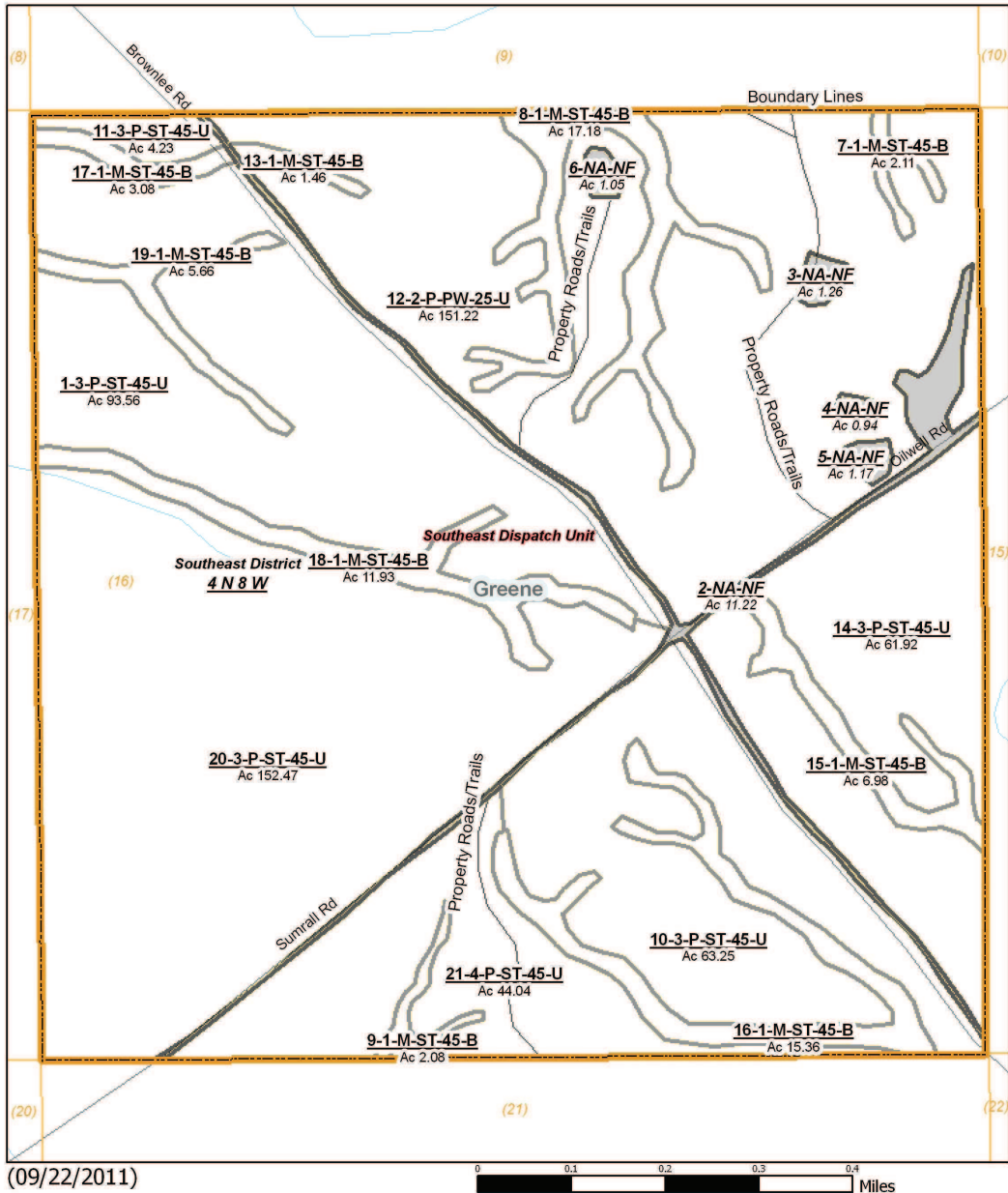

Map 3



**Section 16, Township 04 North, Range 08 West**

Boykin Creek Road  
2012 to 2021  
652.18 Acres

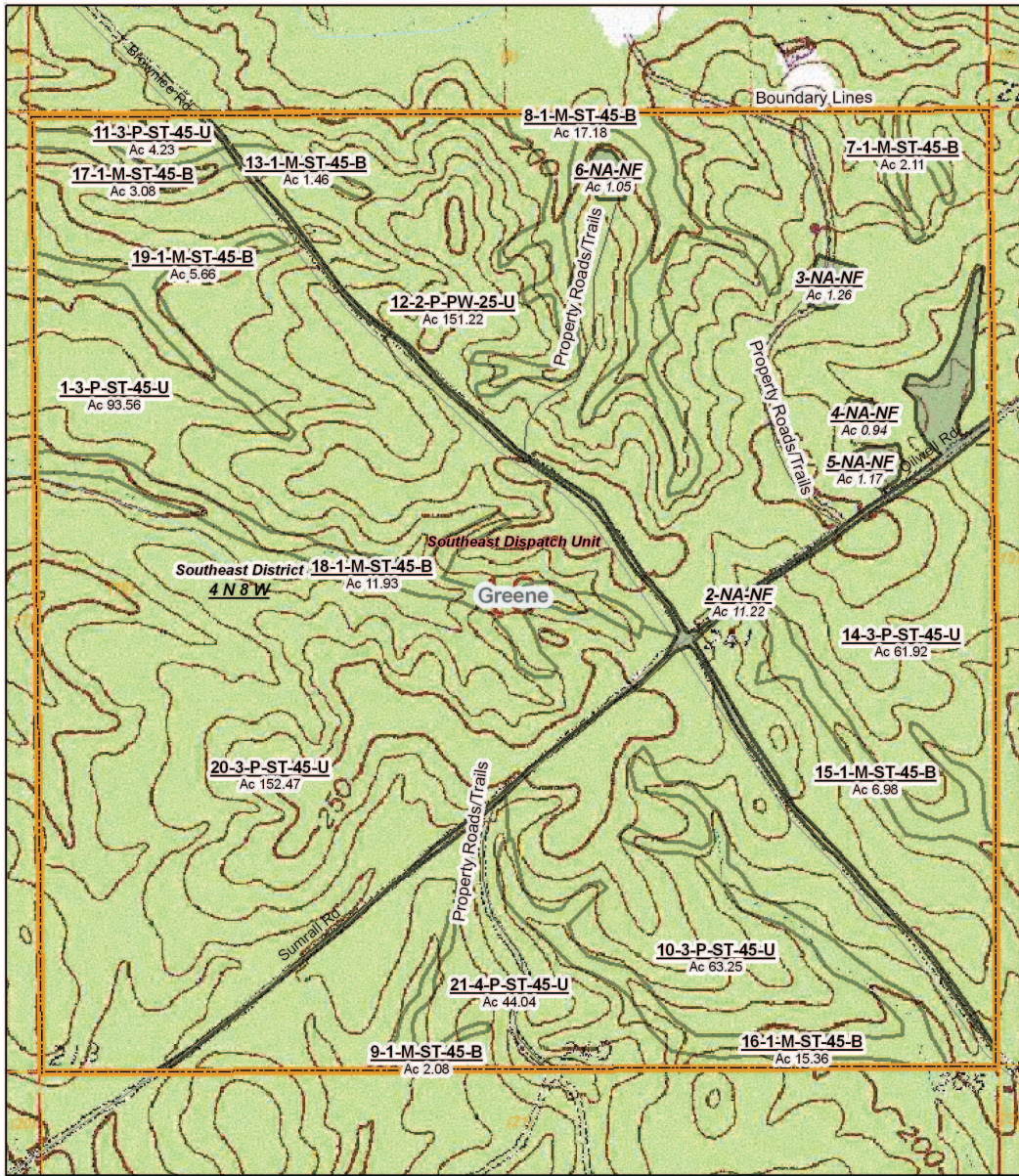

(09/22/2011)





# Legend



## Section 16, Township 04 North, Range 08 West

### Property

Property (1)

### Category 1: Stands

Sawtimber (15)  
 Pulpwood (1)

### Category 3: Non-Forest Stands

Non-Forest (5)

### Property Roads/Trails

Access Road (4)

### Boundary Lines

Property (1)

## MFC Basemap

### County Boundary

County Boundary (1)

### Quadrangle Grid

USGS Quad (1)

### PLS Townships

PLS Townships (1)

### Survey Districts

District 5 (1)

### Blockgroup (Census 2000)

Blockgroup (Census 2000) (1)

### Block (Census 2000)

Block (Census 2000) (5)

### Tract/BNR (Census 2000)

Tract/BNR (Census 2000) (1)

### County Roads

County Roads (6)

### School Sections

School Sections (1)

### Public School Districts

GREENE COUNTY SCHOOL DISTRICT (1)

### US Congressional District

US Cong Dist #4 (1)

### MS Senate

43 (1)

### MS House

105 (1)

### Intermittent Streams

Intermittent Streams (1)

### Hydrologic Units (Basins)

LOWER LEAF RIVER (1)

### Historic Forest Boundary

Longleaf Pine with Loblolly Pine-Slash Pine (1)

### MS Forest Habitat

SOUTHERN CLAY HILLS (1)

### Physiographic Region

Pine Belt (1)

### Soil Associations

mclaurin-savannah-susquehanna (1)

### Surface Geology

PASCAGOULA/HATTIESBURG (1)

### MFC Districts

MFC Districts (1)

### MFC Dispatch Units

MFC Dispatch Units (1)

### MS Outline

MS Outline (1)

Stand Activity Schedule for  
Greene County BOE  
16 4N 8W

Strata	Stand	Activity	Acre	Est. Cost	Est. Revenue
<b>2015</b>					
2	12	Harvest, Mechanical, 1st Thin, Machine, Slash	151	\$5,285.00	\$48,546.50
Yearly Totals			151	\$5,285.00	\$48,546.50
<b>2016</b>					
4	21	Harvest, Mechanical, Final, Machine, Longleaf	44	\$1,540.00	\$88,852.28
Yearly Totals			44	\$1,540.00	\$88,852.28
<b>2017</b>					
2	12	Fire Protection, Other, Burn, Hand, Fuel Reduction	151	\$3,775.00	\$0.00
3	1	Harvest, Mechanical, Final, Machine, Misc Pine	94	\$3,290.00	\$190,883.92
Yearly Totals			245	\$7,065.00	\$190,883.92
<b>2018</b>					
4	21	Regeneration, Artificial, Plant, Hand, Loblolly	44	\$3,300.00	\$0.00
4	21	Site Preparation, Other, Burn, Hand, Debris	44	\$1,100.00	\$0.00
4	21	Site Preparation, Chemical, Broadcast, Aerial, Combination	44	\$3,960.00	\$0.00
Yearly Totals			132	\$8,360.00	\$0.00
<b>2019</b>					
3	1	Regeneration, Artificial, Plant, Hand, Loblolly	94	\$7,520.00	\$0.00
3	1	Site Preparation, Other, Burn, Hand, Cut-Over	94	\$2,350.00	\$0.00
3	1	Site Preparation, Chemical, Broadcast, Aerial, Combination	94	\$8,460.00	\$0.00
Yearly Totals			282	\$18,330.00	\$0.00
<b>2020</b>					
3	11	Harvest, Mechanical, Final, Machine, Misc Pine	4	\$140.00	\$8,122.72

Strata	Stand	Activity	Acre	Est. Cost	Est. Revenue	
3	20	Harvest, Mechanical, Final, Machine, Misc Pine	152	\$5,320.00	\$308,663.36	
			Yearlv Totals	156	\$5,460.00	\$316,786.08
2021						
3	10	Harvest, Mechanical, Final, Machine, Misc Pine	63	\$2,205.00	\$127,932.84	
3	14	Harvest, Mechanical, Final, Machine, Misc Pine	62	\$2,170.00	\$125,902.16	
			Yearlv Totals	125	\$4.375.00	\$253.835.00
			Grand Totals	1.135	\$50.415.00	\$898.903.78